

Section I — +/– Feet & Inches

417

1. $18' 6'' - 10' 3'' =$

5. $11' 9'' - 3' 10'' =$

2. $17' 10'' - 7' 9'' =$

6. $12' 2'' - 10' 4'' =$

3. $13' 2'' + 12' 2'' =$

7. $13' 7'' - 8' 1'' =$

4. $10' 2'' - 7' 11'' =$

8. $14' 6'' - 6' 7'' =$

DRAWING IS NOT TO SCALE

417

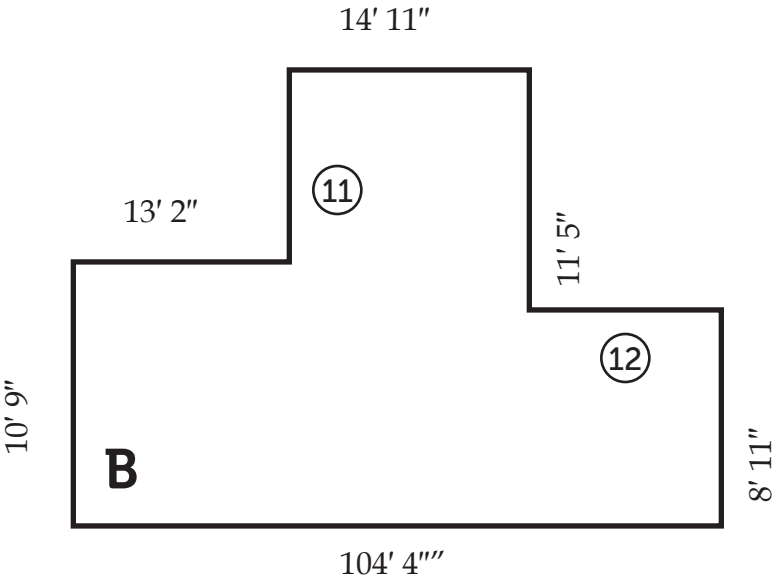
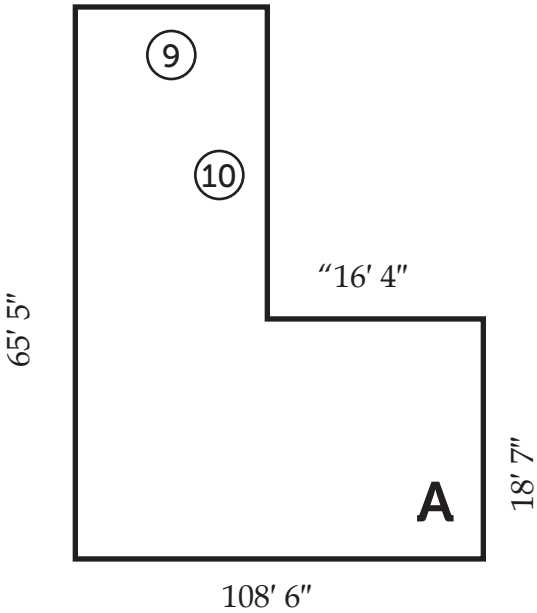

Side	Length	Side	Length	Shape	Perimeter
⑨	_____	⑪	_____	A	⑬ _____
⑩	_____	⑫	_____	B	⑭ _____

DRAWING IS NOT TO SCALE

Section III — Ruler Measurements

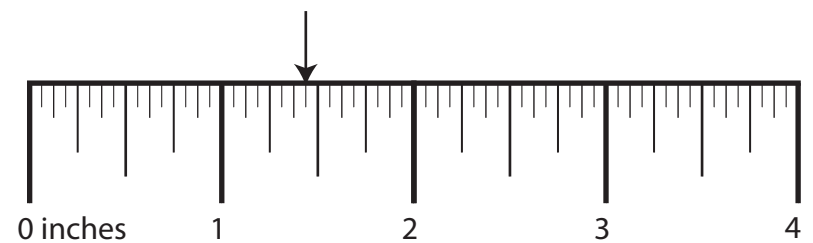
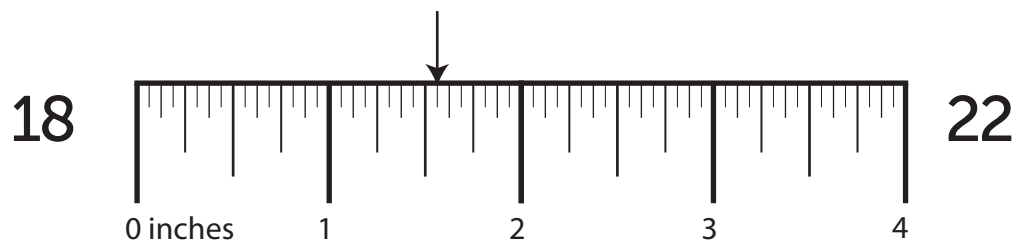
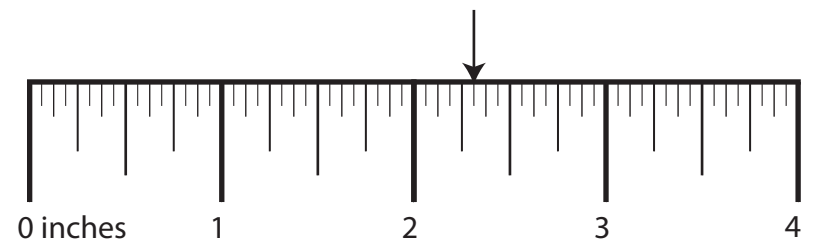
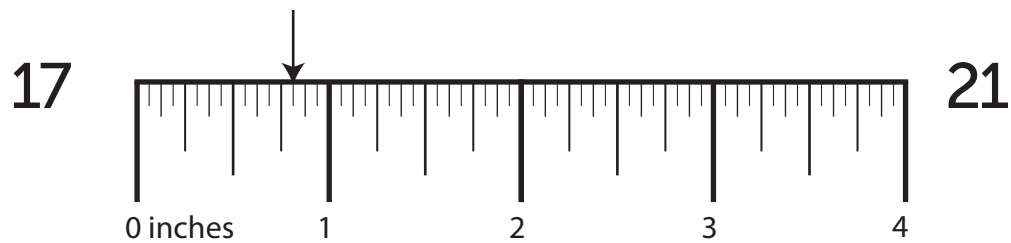
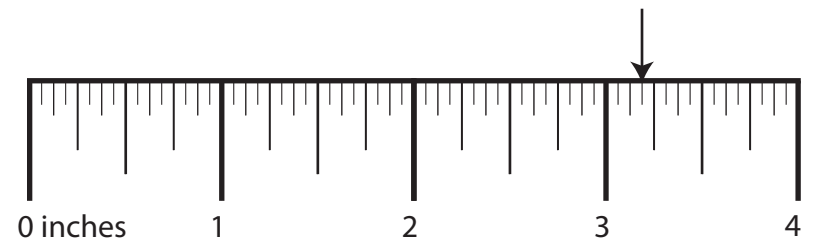
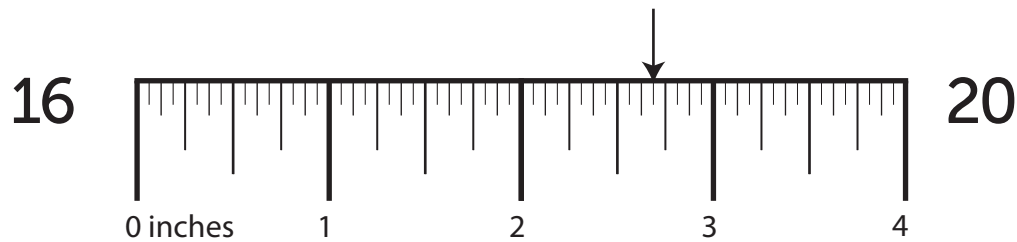
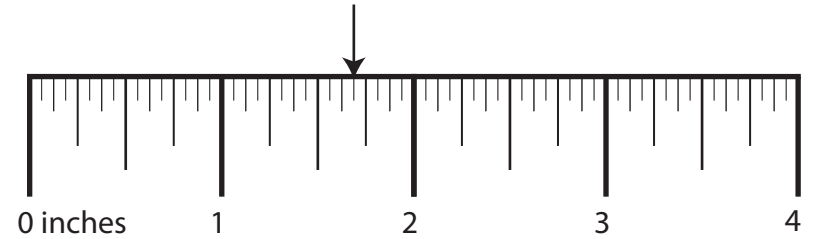
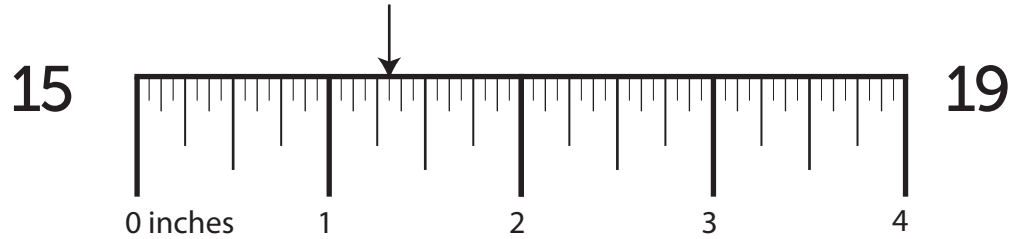

Section IV — More/Less Than

417

23. What is $\frac{1}{4}$ more than $4\frac{1}{4}$? 27. What is $\frac{1}{2}$ less than $5\frac{3}{16}$?
24. What is $\frac{1}{4}$ less than $3\frac{1}{8}$? 28. What is $\frac{5}{16}$ less than $1\frac{1}{4}$?
25. What is $\frac{1}{8}$ less than $5\frac{1}{4}$? 29. What is $\frac{3}{8}$ more than $4\frac{1}{4}$?
26. What is $\frac{1}{4}$ more than $5\frac{5}{16}$? 30. What is $\frac{1}{2}$ less than $2\frac{1}{8}$?

Section V — Nail Penetration & Screw Hole Bits

How far will a ...

What size drill bit will you need to drill a ...

31. 10 ½ box gauge nail penetrate a 4 ½" green beam?

35. pilot hole for a 11 gauge screw?

32. 8 box gauge nail penetrate a 5/8" dry timber?

36. countersink hole for a 7 gauge screw?

33. 16 penny nail penetrate a 2 ½" dry dimension?

37. clearance hole for a 10 gauge screw?

34. 15 ½ box gauge nail penetrate a 3" dry mast?

38. countersink hole for a 8 gauge screw?