

## Section I — +/– Feet &amp; Inches

# 416

---

1.  $15' 4'' + 18' 3'' =$

5.  $14' 5'' - 11' 9'' =$

2.  $15' 7'' - 8' 9'' =$

6.  $12' 3'' + 10' 2'' =$

3.  $18' 8'' + 10' 11'' =$

7.  $10' 4'' - 1' 6'' =$

4.  $13' 10'' - 4' 5'' =$

8.  $18' 11'' + 18' 7'' =$

DRAWING IS NOT TO SCALE

416

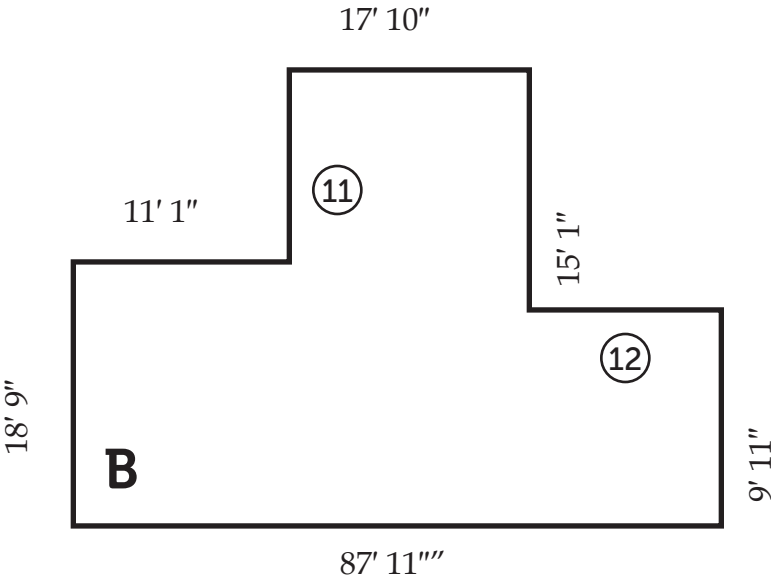
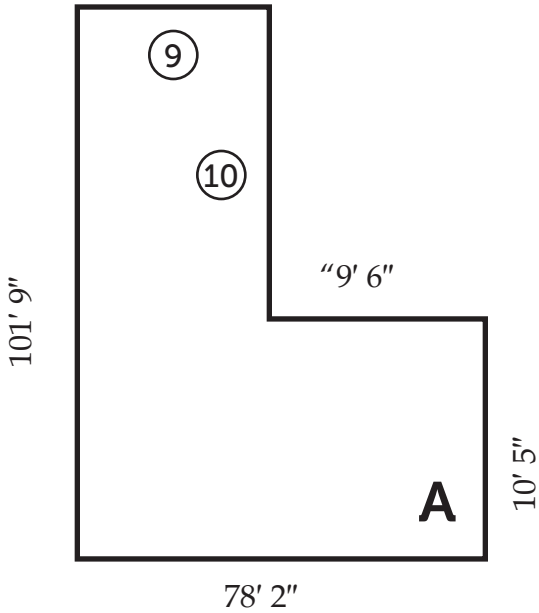

Side	Length	Side	Length	Shape	Perimeter
⑨	_____	⑪	_____	A	⑬ _____
⑩	_____	⑫	_____	B	⑭ _____

# DRAWING IS NOT TO SCALE

## Section III — Ruler Measurements

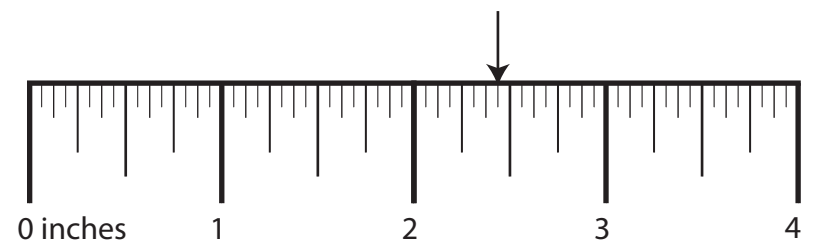
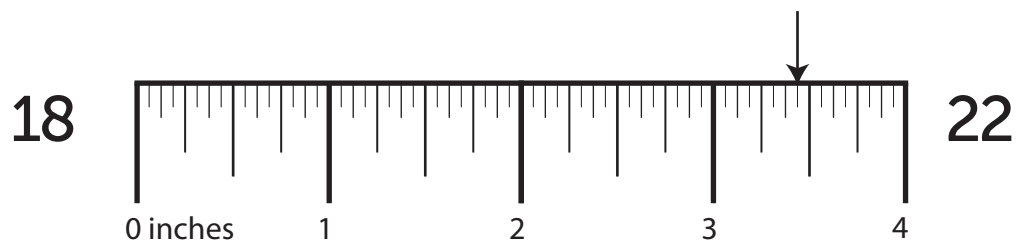
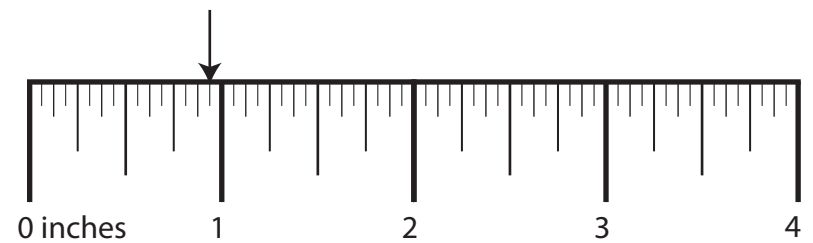
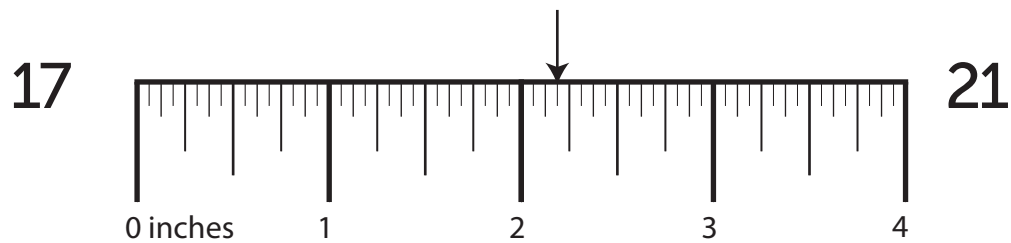
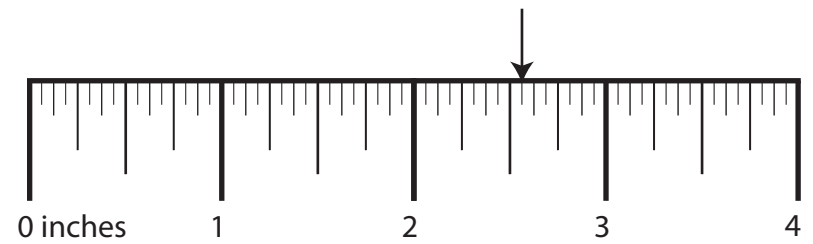
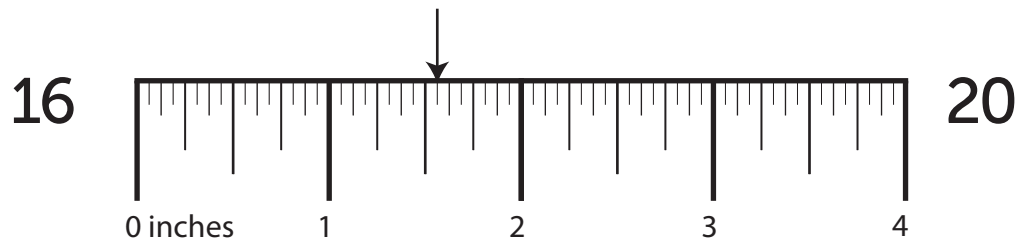
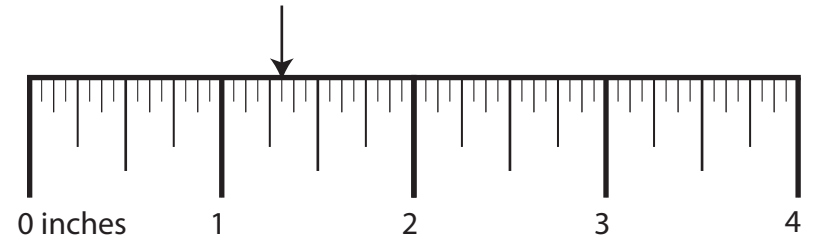
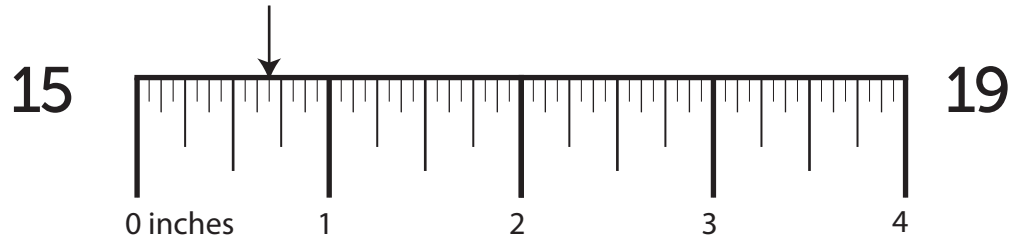

## Section IV — More/Less Than

# 4 1 6

---

23. What is  $\frac{1}{2}$  more than  $4 \frac{3}{8}$ ?      27. What is  $\frac{5}{16}$  less than  $2 \frac{1}{2}$ ?
24. What is  $\frac{5}{16}$  less than  $2 \frac{1}{4}$ ?      28. What is  $\frac{1}{4}$  less than  $5 \frac{3}{16}$ ?
25. What is  $\frac{1}{8}$  more than  $5 \frac{1}{8}$ ?      29. What is  $\frac{3}{8}$  more than  $3 \frac{5}{16}$ ?
26. What is  $\frac{1}{16}$  more than  $3 \frac{1}{8}$ ?      30. What is  $\frac{1}{16}$  more than  $1 \frac{5}{16}$ ?

## Section V — Nail Penetration & Screw Hole Bits

How far will a ...

What size drill bit will you need to drill a ...

31. 16 penny nail penetrate a  $\frac{3}{4}$ " green pole?

35. clearance hole for a 16 gauge screw?

32. 50 penny nail penetrate a 4" green joist?

36. countersink hole for a 10 gauge screw?

33. 16 penny nail penetrate a  $2\frac{1}{2}$ " green timber?

37. clearance hole for a 1 gauge screw?

34. 8 penny nail penetrate a 2" green frame?

38. clearance hole for a 6 gauge screw?