

Section I — +/– Feet & Inches

4 1 3

1. $9' 9'' + 15' 7'' =$

5. $18' 9'' - 7' 4'' =$

2. $9' 8'' - 9' 7'' =$

6. $17' 3'' + 9' 9'' =$

3. $8' 8'' + 8' 2'' =$

7. $14' 3'' - 8' 9'' =$

4. $16' 2'' - 8' 7'' =$

8. $9' 9'' - 3' 10'' =$

DRAWING IS NOT TO SCALE

413

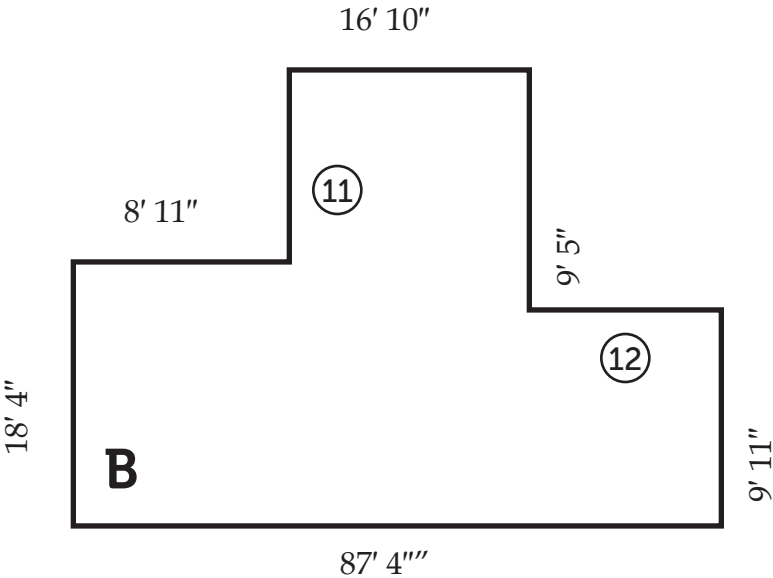
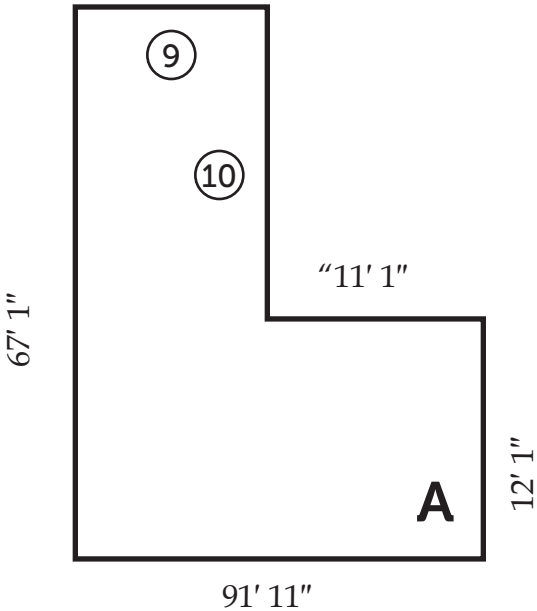

Side	Length	Side	Length	Shape	Perimeter
9		11		A	13
10		12		B	14

DRAWING IS NOT TO SCALE

Section III — Ruler Measurements

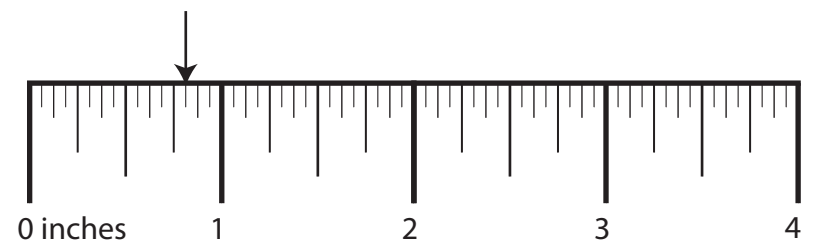
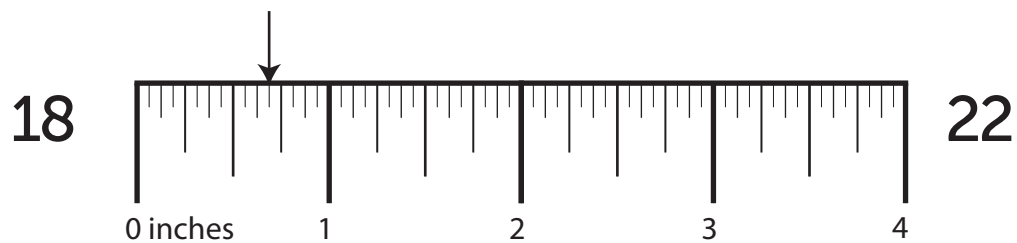
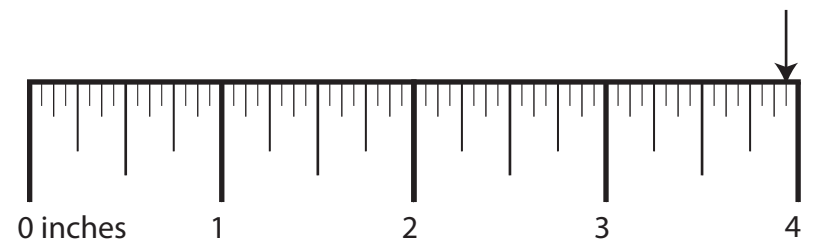
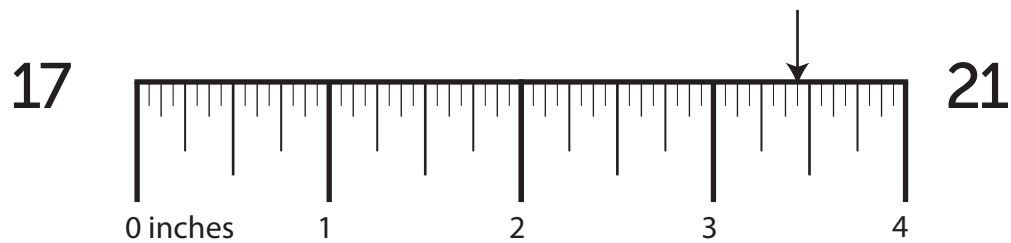
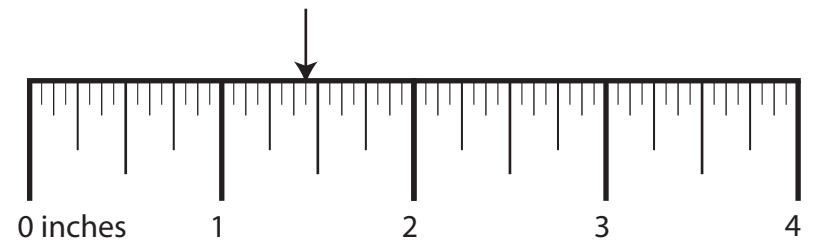
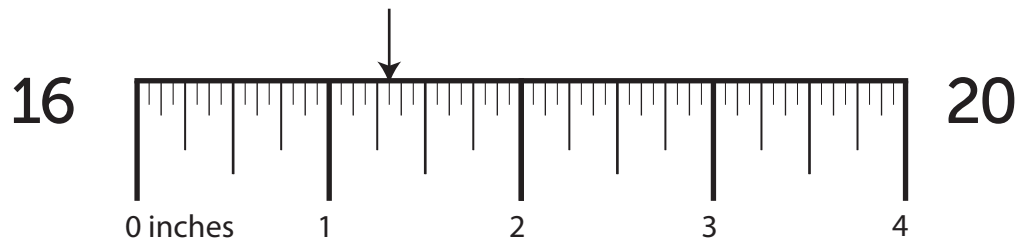
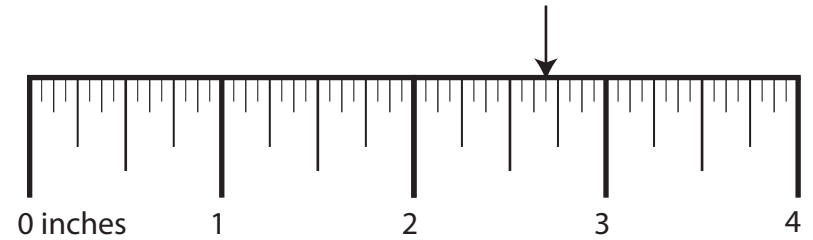
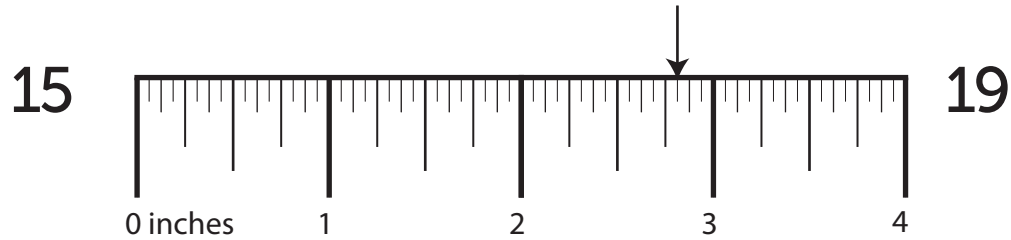

Section IV — More/Less Than

413

23. What is $\frac{1}{2}$ less than $2\frac{1}{4}$? 27. What is $\frac{1}{4}$ more than $2\frac{1}{2}$?
24. What is $\frac{1}{2}$ more than $5\frac{1}{16}$? 28. What is $\frac{1}{2}$ more than $1\frac{1}{4}$?
25. What is $\frac{1}{4}$ less than $2\frac{1}{16}$? 29. What is $\frac{3}{8}$ less than $4\frac{3}{16}$?
26. What is $\frac{1}{2}$ less than $2\frac{1}{2}$? 30. What is $\frac{3}{8}$ more than $3\frac{1}{8}$?

Section V — Nail Penetration & Screw Hole Bits

How far will a ...

What size drill bit will you need to drill a ...

31. 2 penny nail penetrate a 1" dry frame?

35. pilot hole for a 7 gauge screw?

32. 9 common gauge nail penetrate a 3" dry mast?

36. countersink hole for a 11 gauge screw?

33. 9 box gauge nail penetrate a 4" green timber?

37. countersink hole for a 18 gauge screw?

34. 10 ¼ common gauge nail penetrate a 1 ¼" dry pole?

38. pilot hole for a 9 gauge screw?