

Section I — +/– Feet & Inches

4 1 1

1. $9' 9'' - 7' 2'' =$

5. $12' 7'' + 11' 2'' =$

2. $11' 5'' + 14' 3'' =$

6. $15' 9'' + 10' 6'' =$

3. $17' 1'' + 10' 7'' =$

7. $10' 1'' - 4' 10'' =$

4. $13' 2'' - 3' 8'' =$

8. $13' 4'' - 7' 4'' =$

DRAWING IS NOT TO SCALE

411

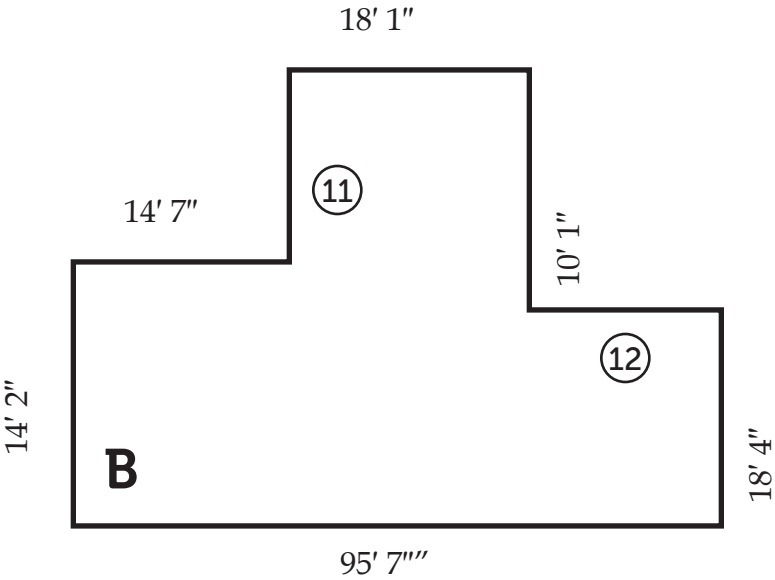
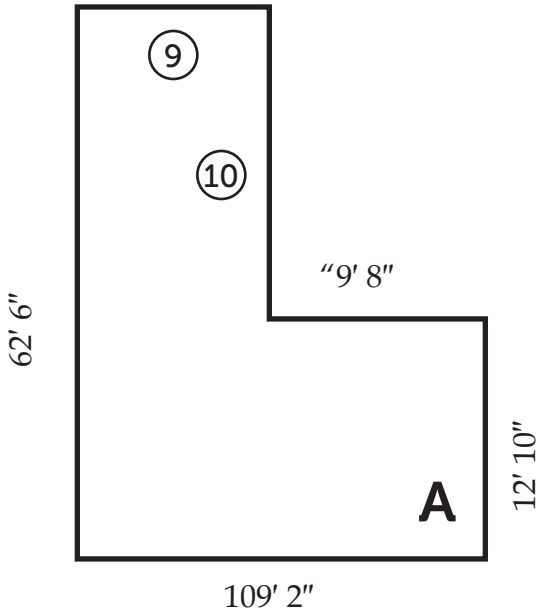

Side	Length	Side	Length	Shape	Perimeter
9	_____	11	_____	A	13 _____
10	_____	12	_____	B	14 _____

DRAWING IS NOT TO SCALE

Section III — Ruler Measurements

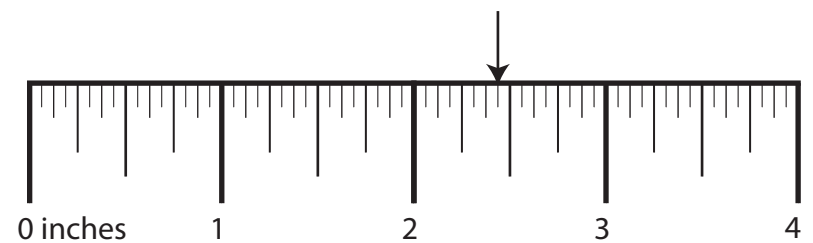
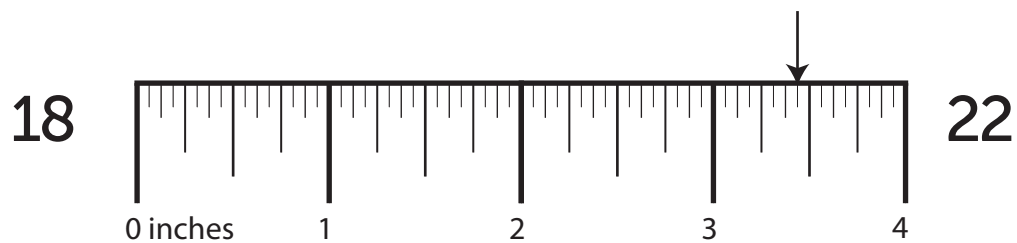
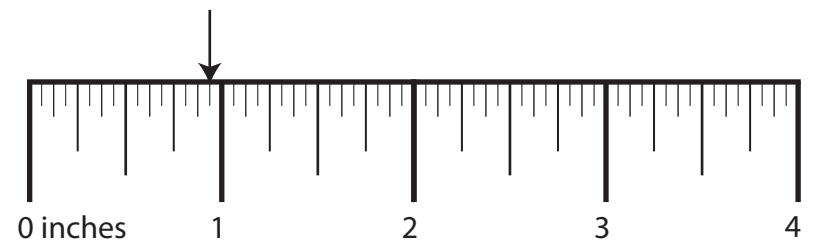
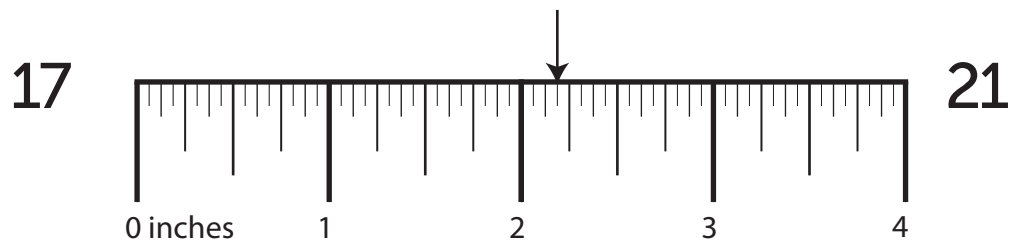
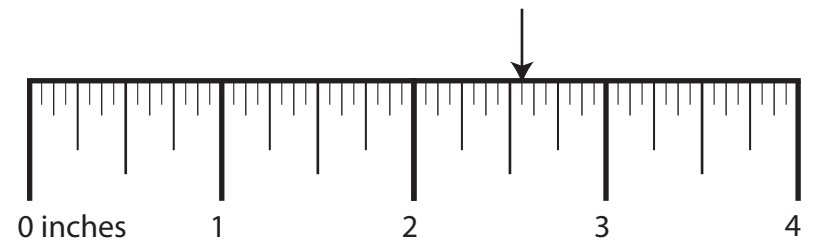
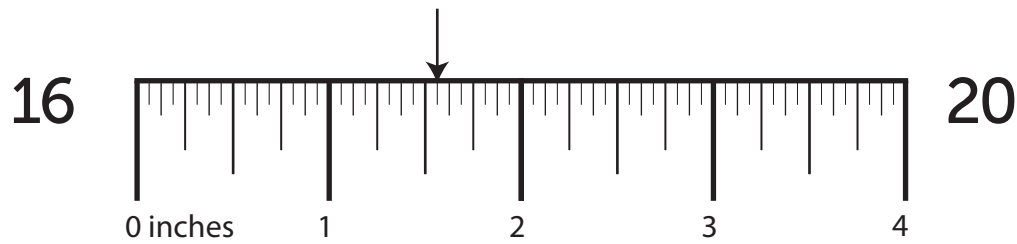
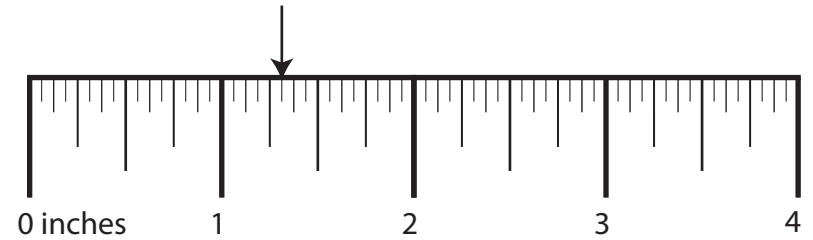
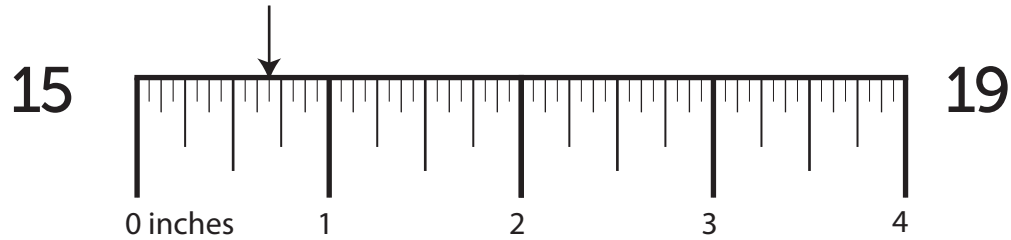

Section IV — More/Less Than

4 1 1

23. What is $\frac{1}{2}$ more than $1 \frac{1}{2}$? 27. What is $\frac{3}{8}$ more than $2 \frac{5}{16}$?

24. What is $\frac{1}{2}$ more than $3 \frac{1}{4}$? 28. What is $\frac{1}{2}$ less than $3 \frac{1}{2}$?

25. What is $\frac{3}{16}$ more than $3 \frac{1}{4}$? 29. What is $\frac{1}{4}$ more than $2 \frac{1}{2}$?

26. What is $\frac{1}{8}$ more than $3 \frac{1}{2}$? 30. What is $\frac{5}{16}$ more than $4 \frac{5}{16}$?

Section V — Nail Penetration & Screw Hole Bits

How far will a ...

What size drill bit will you need to drill a ...

31. 60 penny nail penetrate a 2 ½" green girder?

35. countersink hole for a 20 gauge screw?

32. 4 penny nail penetrate a 2 ½" green dimension?

36. pilot hole for a 8 gauge screw?

33. 6 penny nail penetrate a 4 ½" dry mast?

37. pilot hole for a 1 gauge screw?

34. 2 penny nail penetrate a 1 ¼" green board?

38. pilot hole for a 24 gauge screw?