

Section I — +/– Feet & Inches

410

1. $12' 2'' + 15' 3'' =$

5. $13' 11'' + 14' 8'' =$

2. $12' 3'' + 16' 1'' =$

6. $10' 3'' + 14' 7'' =$

3. $18' 8'' + 15' 1'' =$

7. $15' 7'' - 4' 4'' =$

4. $15' 10'' - 2' 4'' =$

8. $12' 1'' - 11' 8'' =$

410

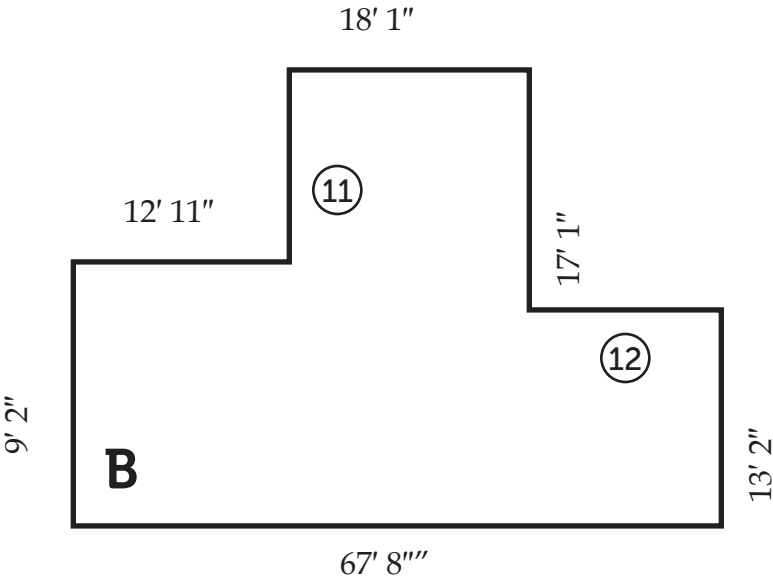
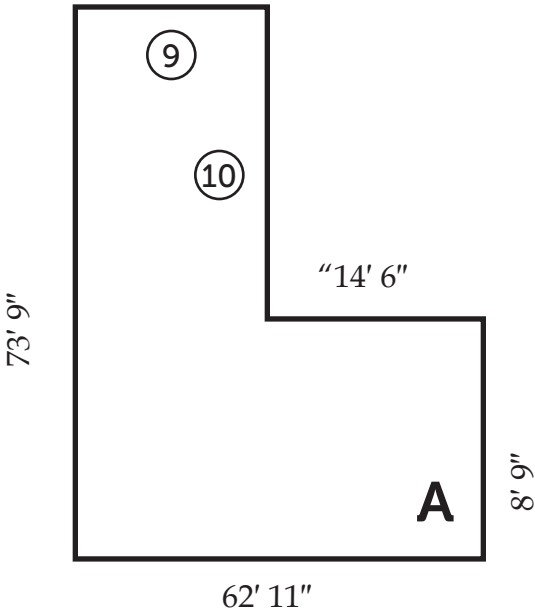

| Side | Length | Side | Length | Shape | Perimeter |
|------|--------|------|--------|-------|-----------|
| 9 | _____ | 11 | _____ | A | 13 _____ |
| 10 | _____ | 12 | _____ | B | 14 _____ |

DRAWING IS NOT TO SCALE

Section III — Ruler Measurements

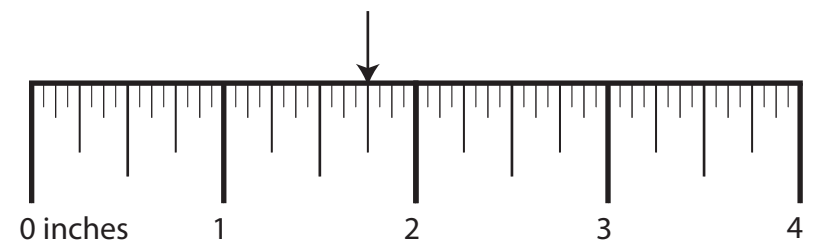
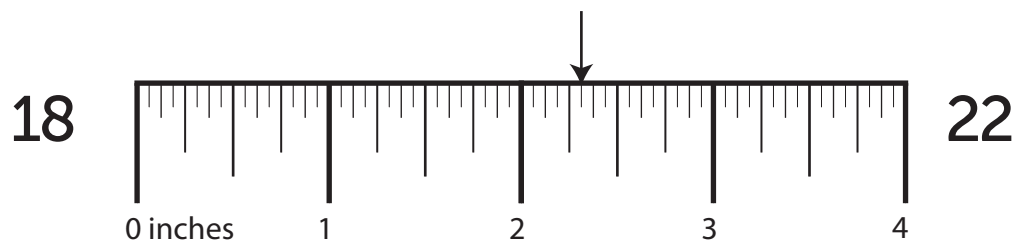
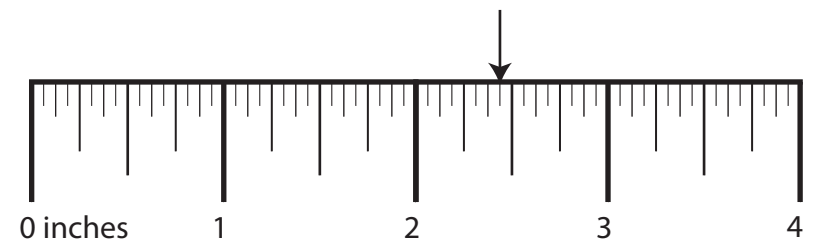
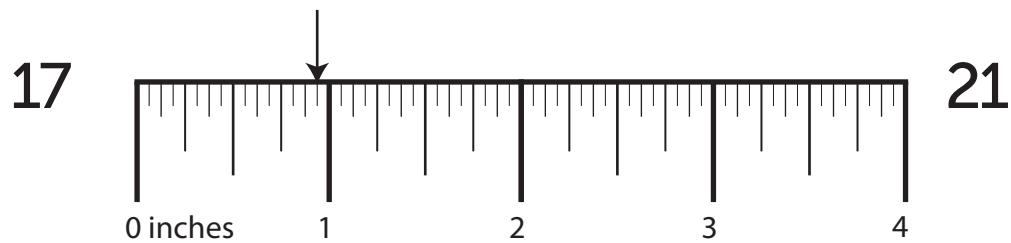
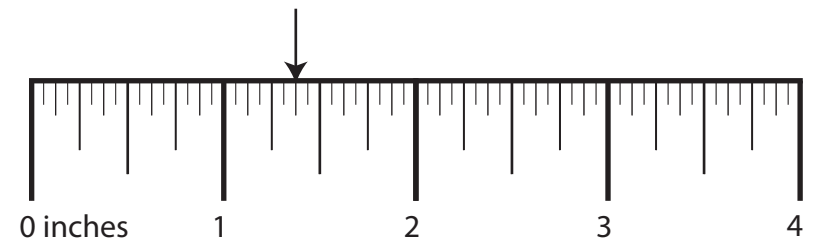
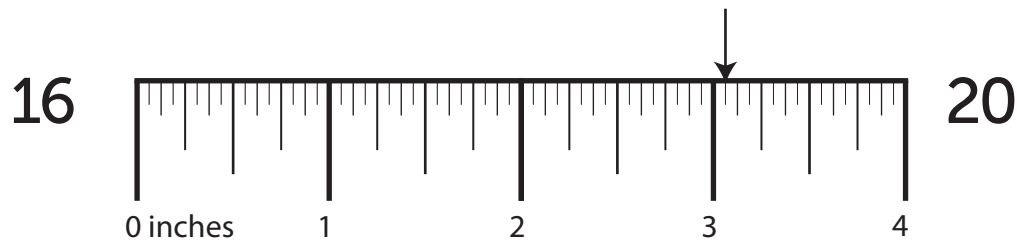
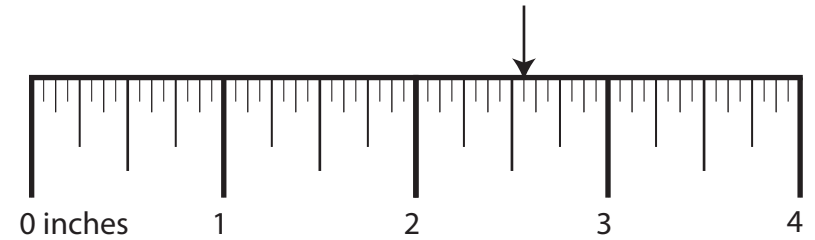
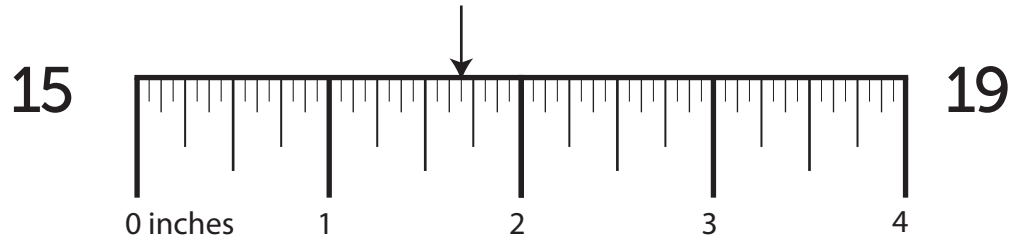

Section IV — More/Less Than

410

23. What is $\frac{3}{16}$ more than $3\frac{1}{4}$? 27. What is $\frac{1}{2}$ less than $3\frac{1}{2}$?
24. What is $\frac{1}{2}$ more than $5\frac{1}{4}$? 28. What is $\frac{1}{4}$ less than $2\frac{5}{16}$?
25. What is $\frac{1}{16}$ more than $1\frac{1}{4}$? 29. What is $\frac{1}{8}$ less than $1\frac{1}{4}$?
26. What is $\frac{3}{8}$ more than $3\frac{3}{8}$? 30. What is $\frac{3}{8}$ more than $1\frac{3}{8}$?

Section V — Nail Penetration & Screw Hole Bits

How far will a ...

What size drill bit will you need to drill a ...

31. 12 ½ common gauge nail penetrate a 2" green girder?

35. clearance hole for a 20 gauge screw?

32. 14 ½ box gauge nail penetrate a ½" green board?

36. pilot hole for a 10 gauge screw?

33. 3 penny nail penetrate a ½" dry frame?

37. countersink hole for a 7 gauge screw?

34. 20 penny nail penetrate a 2" dry timber?

38. pilot hole for a 3 gauge screw?