

Section I — +/– Feet & Inches

409

1. $17' 9'' - 10' 5'' =$

5. $12' 3'' + 8' 9'' =$

2. $9' 2'' - 8' 4'' =$

6. $17' 5'' + 16' 6'' =$

3. $12' 5'' + 18' 8'' =$

7. $15' 11'' + 11' 10'' =$

4. $18' 7'' - 11' 11'' =$

8. $16' 9'' - 1' 1'' =$

DRAWING IS NOT TO SCALE

409

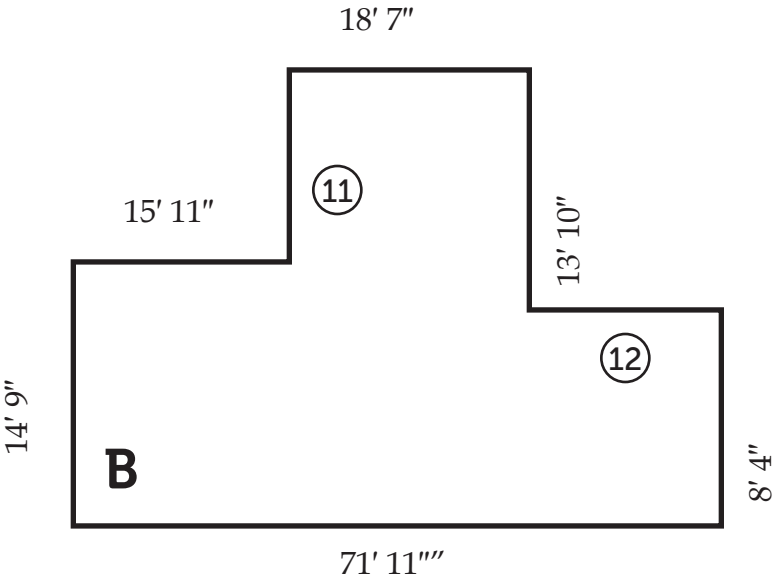
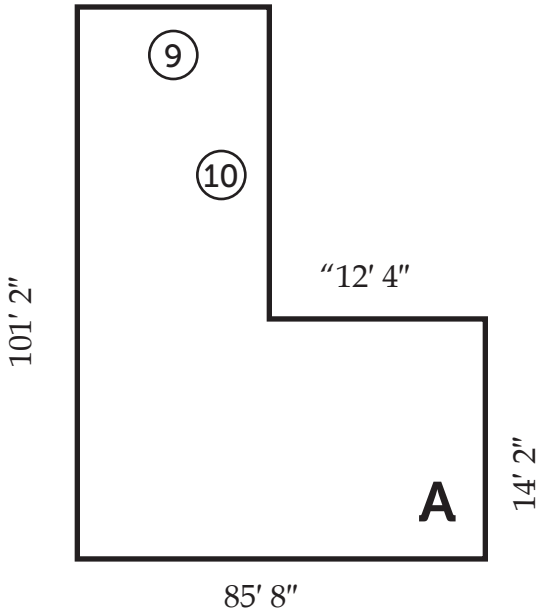

Side	Length	Side	Length	Shape	Perimeter
9		11		A	13
10		12		B	14

DRAWING IS NOT TO SCALE

Section III — Ruler Measurements

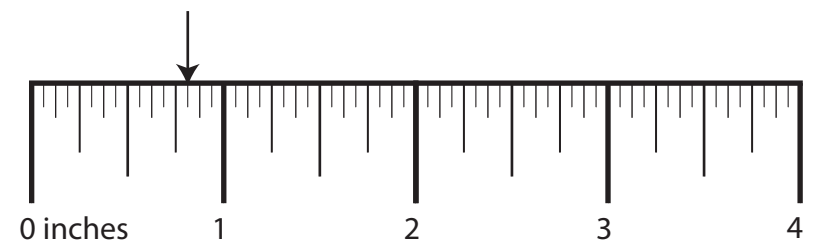
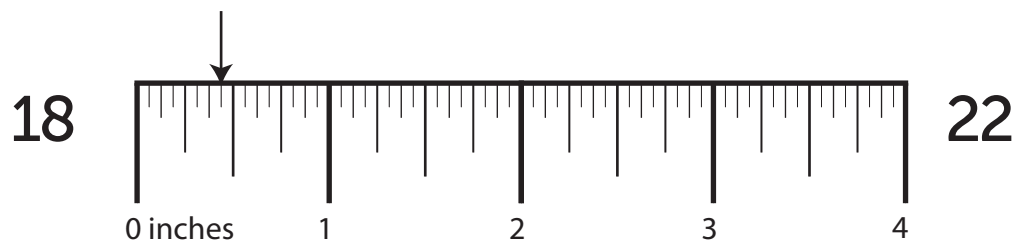
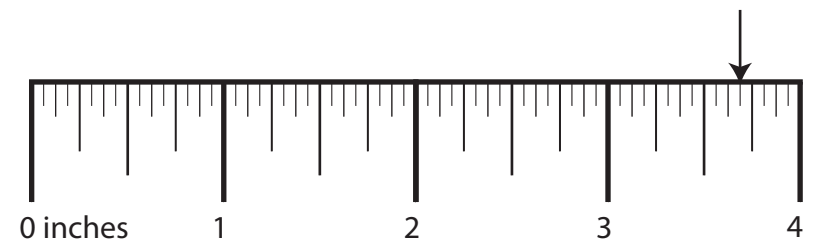
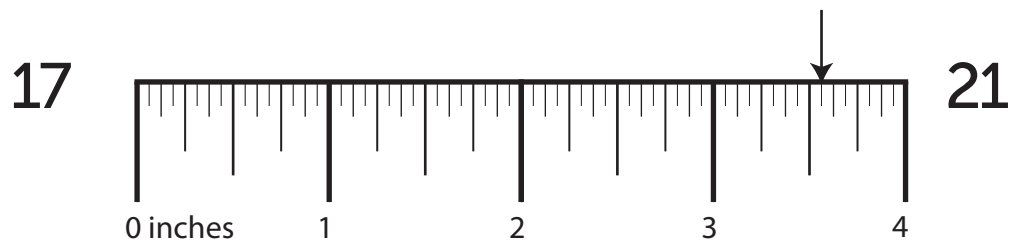
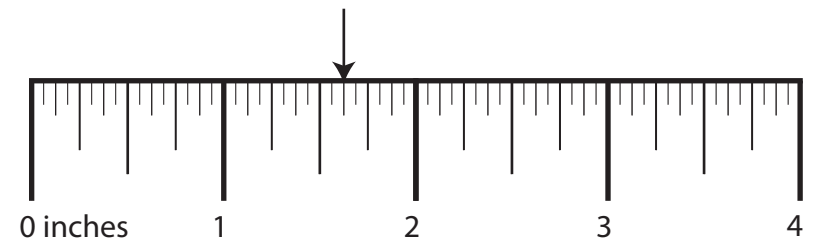
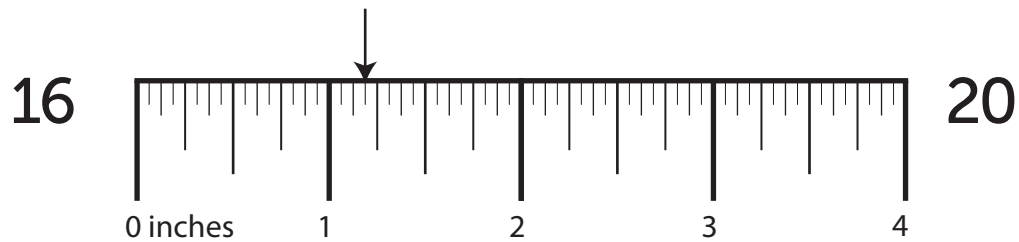
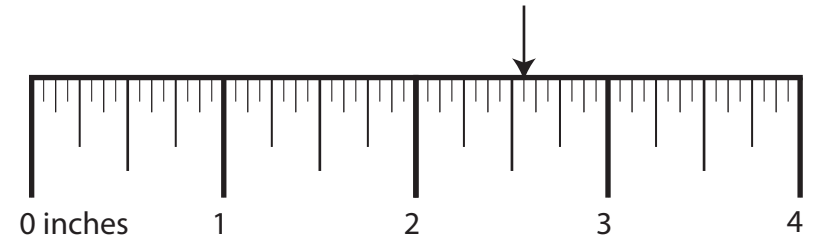
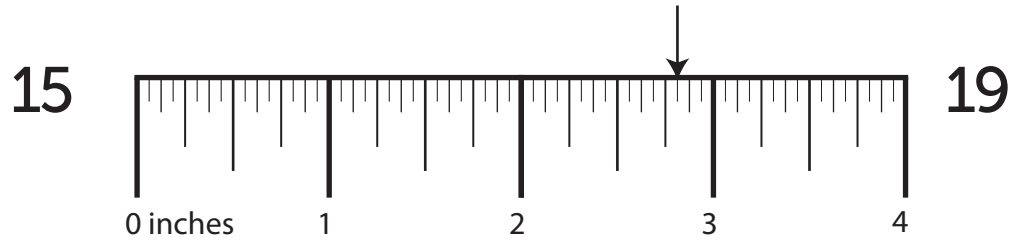

Section IV — More/Less Than

409

23. What is $\frac{3}{8}$ more than $1 \frac{3}{8}$? 27. What is $\frac{3}{16}$ more than $2 \frac{1}{4}$?
24. What is $\frac{1}{2}$ more than $3 \frac{1}{2}$? 28. What is $\frac{1}{2}$ more than $1 \frac{1}{4}$?
25. What is $\frac{3}{8}$ more than $1 \frac{5}{16}$? 29. What is $\frac{1}{4}$ less than $1 \frac{1}{8}$?
26. What is $\frac{1}{2}$ less than $1 \frac{3}{8}$? 30. What is $\frac{1}{2}$ less than $3 \frac{1}{8}$?

Section V — Nail Penetration & Screw Hole Bits

How far will a ...

What size drill bit will you need to drill a ...

- | | |
|---|---|
| 31. 7 penny nail penetrate a 1" green girder? | 35. clearance hole for a 11 gauge screw? |
| 32. 10 ¼ common gauge nail penetrate a 3 ½" dry mast? | 36. clearance hole for a 18 gauge screw? |
| 33. 30 penny nail penetrate a 3/8" dry beam? | 37. clearance hole for a 10 gauge screw? |
| 34. 60 penny nail penetrate a 4 ½" green joist? | 38. countersink hole for a 2 gauge screw? |