

## Section I — +/– Feet &amp; Inches

# 408

---

1.  $17' 5'' - 8' 3'' =$

5.  $16' 11'' - 8' 9'' =$

2.  $9' 5'' - 8' 8'' =$

6.  $18' 11'' - 3' 10'' =$

3.  $15' 11'' - 8' 8'' =$

7.  $18' 4'' + 15' 9'' =$

4.  $16' 7'' - 11' 3'' =$

8.  $13' 4'' - 6' 3'' =$

408

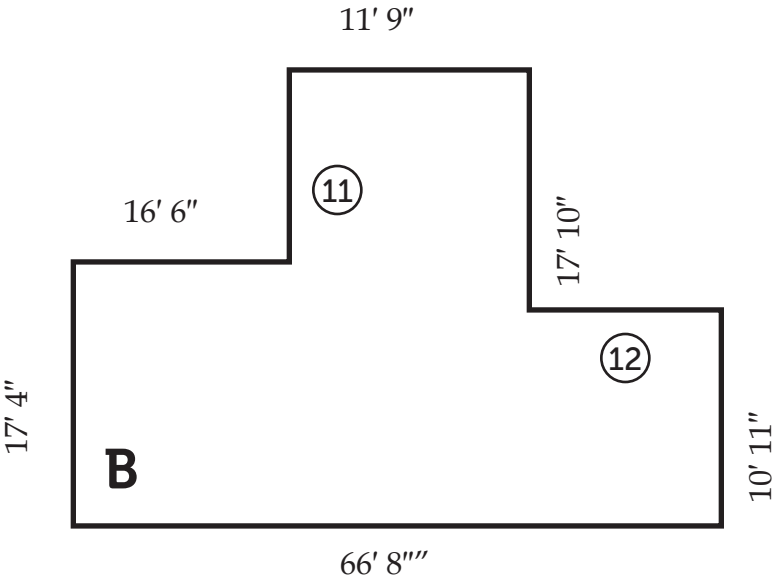
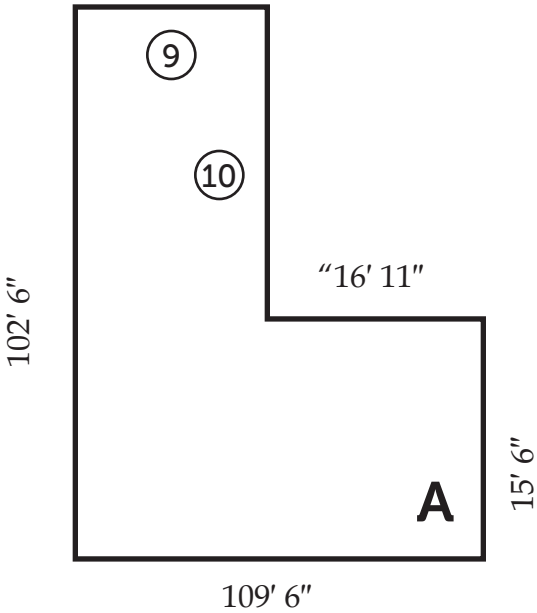

Side	Length	Side	Length	Shape	Perimeter
⑨	_____	⑪	_____	A	⑬ _____
⑩	_____	⑫	_____	B	⑭ _____

# DRAWING IS NOT TO SCALE

## Section III — Ruler Measurements

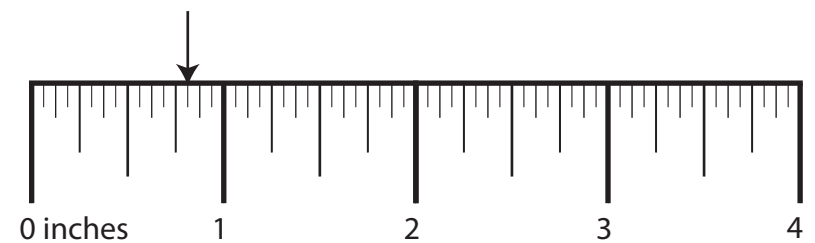
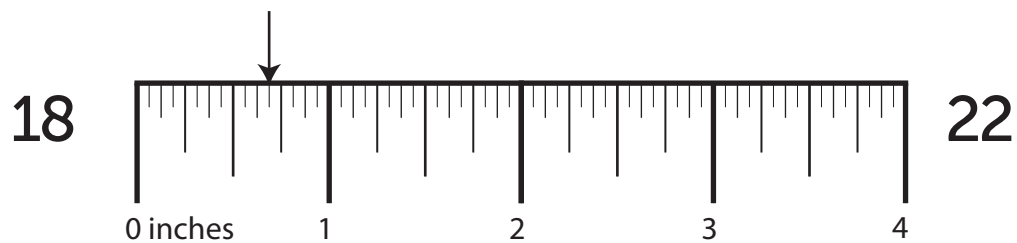
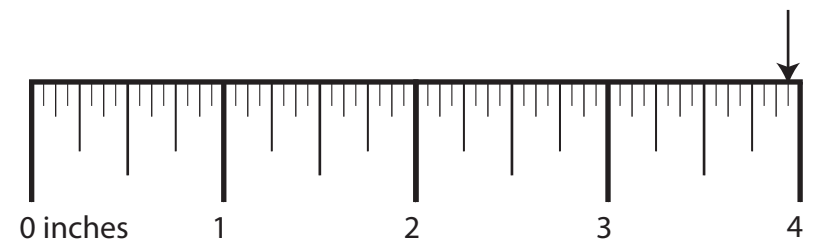
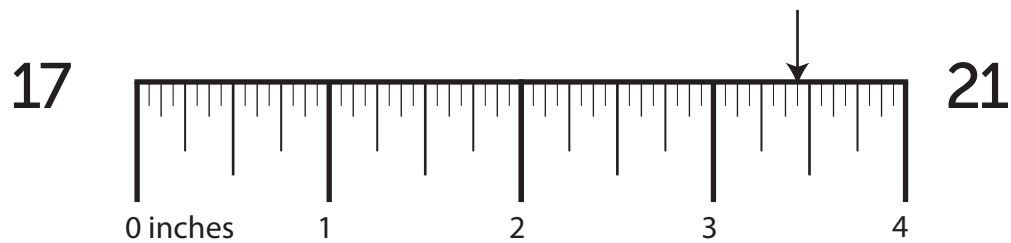
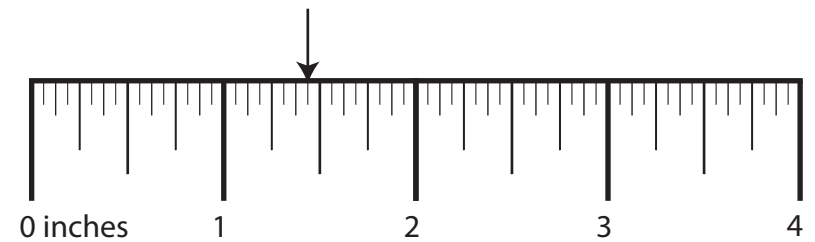
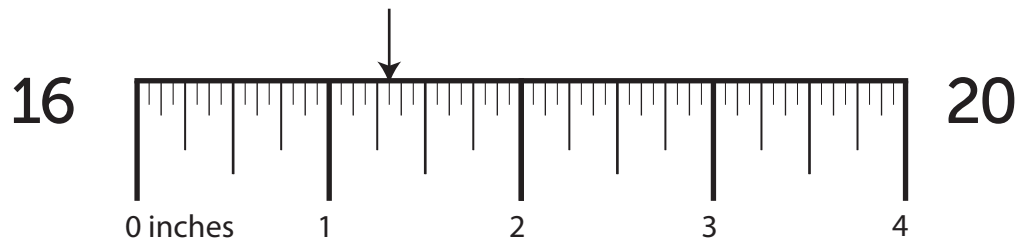
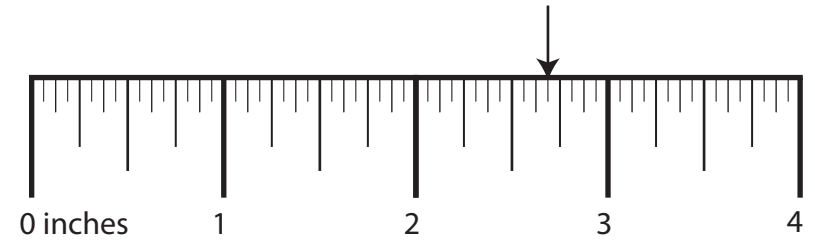
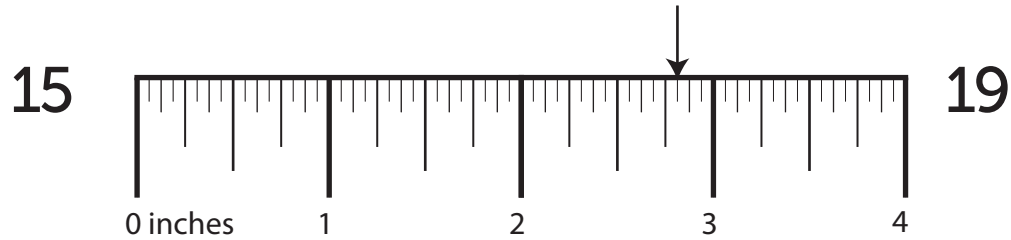

## Section IV — More/Less Than

# 408

---

23. What is  $\frac{1}{8}$  more than  $2\frac{3}{8}$ ?      27. What is  $\frac{5}{16}$  more than  $5\frac{1}{2}$ ?
24. What is  $\frac{1}{4}$  less than  $1\frac{1}{2}$ ?      28. What is  $\frac{1}{2}$  more than  $4\frac{5}{16}$ ?
25. What is  $\frac{1}{4}$  more than  $5\frac{1}{4}$ ?      29. What is  $\frac{5}{16}$  less than  $3\frac{3}{16}$ ?
26. What is  $\frac{1}{2}$  less than  $1\frac{5}{16}$ ?      30. What is  $\frac{1}{8}$  more than  $5\frac{3}{16}$ ?

## Section V — Nail Penetration & Screw Hole Bits

How far will a ...

What size drill bit will you need to drill a ...

- |     |   |     |  |
|-----|---|-----|--|
| 31. | 14 common gauge nail penetrate a 4 ½" green rafter? | 35. | clearance hole for a 16 gauge screw?   |
|     |   |     |  |
| 32. | 15 ½ box gauge nail penetrate a ½" dry timber?      | 36. | countersink hole for a 4 gauge screw?  |
|     |   |     |  |
| 33. | 7 penny nail penetrate a 2" dry rafter?             | 37. | clearance hole for a 16 gauge screw?   |
|     |   |     |  |
| 34. | 4 penny nail penetrate a 3/8" green plank?          | 38. | countersink hole for a 12 gauge screw? |