

Section I — +/– Feet & Inches

405

1. $18' 10'' - 1' 6'' =$

5. $15' 11'' - 2' 11'' =$

2. $11' 11'' - 4' 7'' =$

6. $17' 10'' + 17' 5'' =$

3. $14' 6'' - 1' 11'' =$

7. $11' 6'' - 4' 8'' =$

4. $13' 4'' + 16' 8'' =$

8. $18' 1'' - 4' 4'' =$

DRAWING IS NOT TO SCALE

405

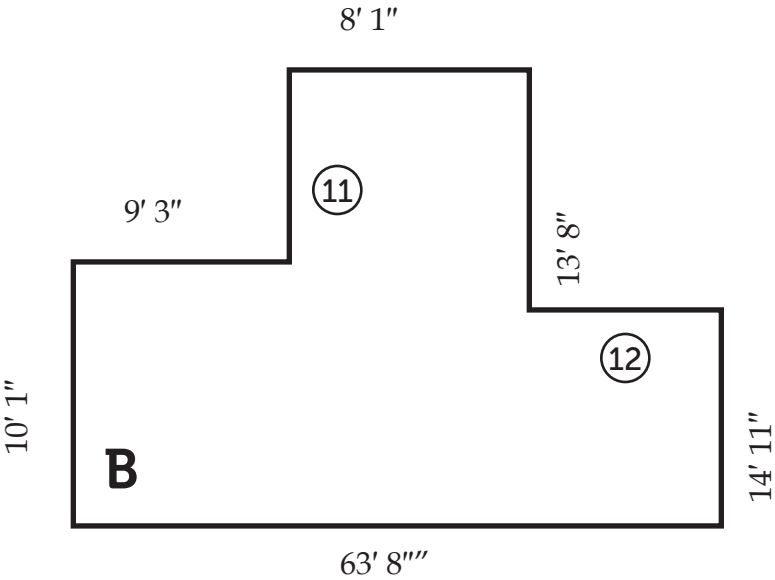
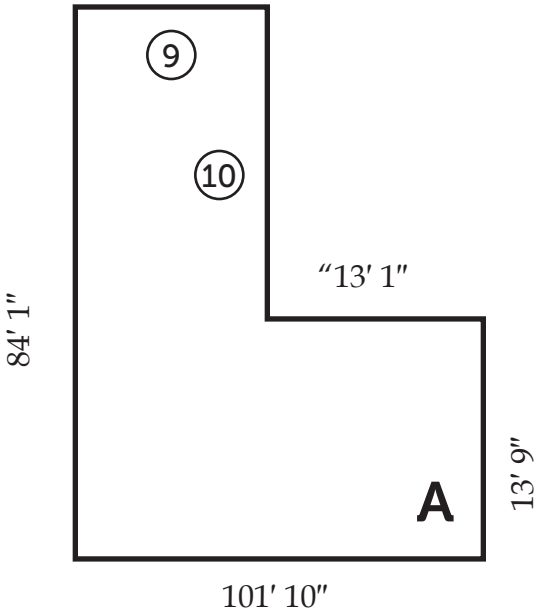

Side	Length	Side	Length	Shape	Perimeter
⑨	_____	⑪	_____	A	⑬ _____
⑩	_____	⑫	_____	B	⑭ _____

DRAWING IS NOT TO SCALE

Section III — Ruler Measurements

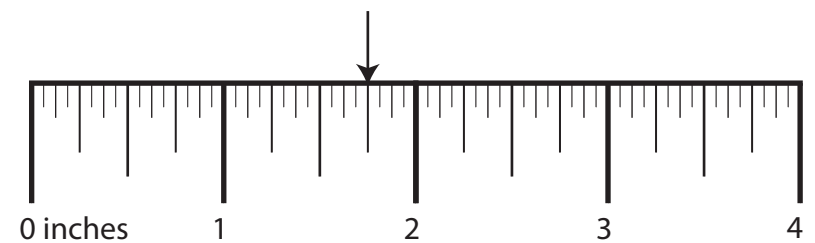
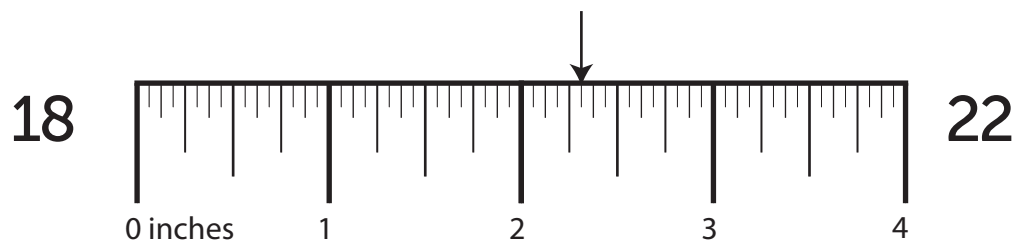
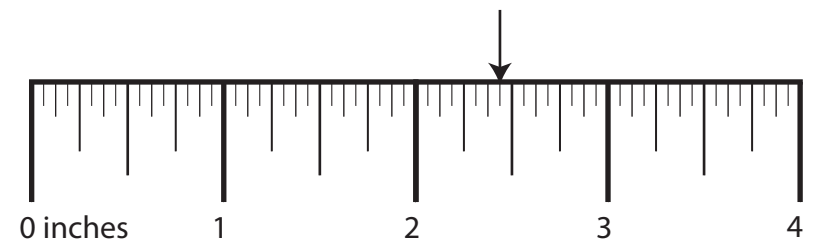
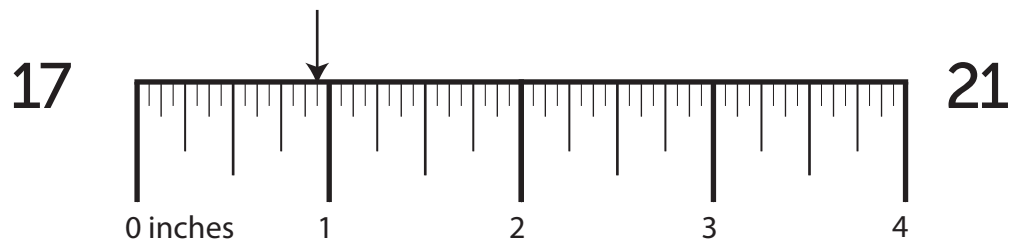
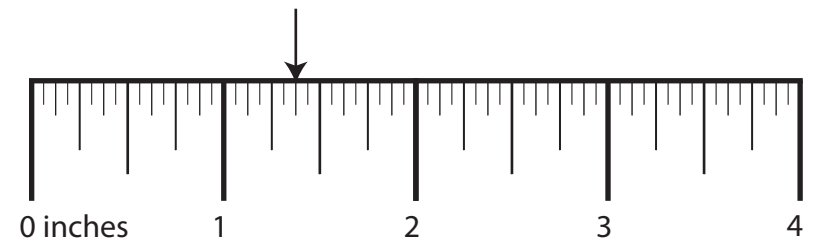
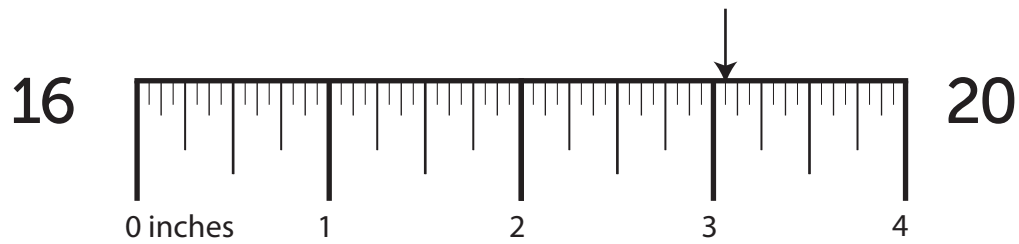
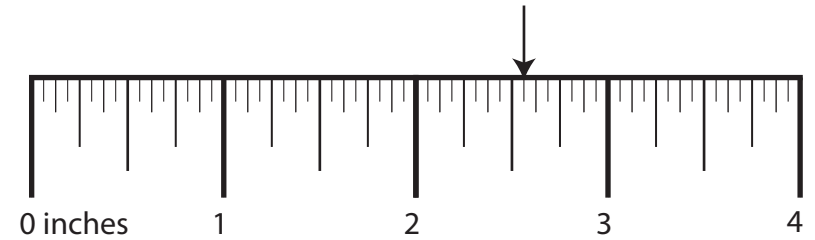
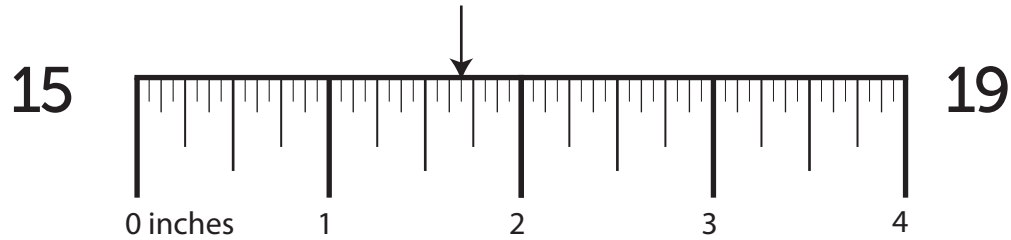

Section IV — More/Less Than

405

23. What is $\frac{1}{16}$ more than $4\frac{3}{8}$? 27. What is $\frac{1}{2}$ more than $3\frac{1}{4}$?
24. What is $\frac{3}{16}$ less than $3\frac{1}{8}$? 28. What is $\frac{3}{16}$ less than $1\frac{3}{8}$?
25. What is $\frac{1}{16}$ less than $4\frac{1}{4}$? 29. What is $\frac{1}{2}$ less than $1\frac{1}{2}$?
26. What is $\frac{1}{2}$ more than $2\frac{5}{16}$? 30. What is $\frac{1}{8}$ more than $4\frac{3}{8}$?

Section V — Nail Penetration & Screw Hole Bits

How far will a ...

What size drill bit will you need to drill a ...

- | | | | |
|-----|--|-----|--|
| 31. | 15 common gauge nail penetrate a $\frac{1}{2}$ " green girder? | 35. | clearance hole for a 11 gauge screw? |
| | | | |
| 32. | 20 penny nail penetrate a 1" green beam? | 36. | countersink hole for a 12 gauge screw? |
| | | | |
| 33. | 60 penny nail penetrate a $\frac{5}{8}$ " green rafter? | 37. | clearance hole for a 5 gauge screw? |
| | | | |
| 34. | 11 $\frac{1}{2}$ box gauge nail penetrate a 2 $\frac{1}{2}$ " green joist? | 38. | countersink hole for a 9 gauge screw? |