

Section I — +/– Feet & Inches

402

1. $15' 4'' + 8' 6'' =$

5. $17' 9'' - 5' 6'' =$

2. $13' 9'' - 4' 5'' =$

6. $16' 4'' + 17' 7'' =$

3. $8' 9'' + 16' 10'' =$

7. $10' 7'' - 10' 1'' =$

4. $12' 1'' + 8' 5'' =$

8. $11' 3'' + 16' 8'' =$

402

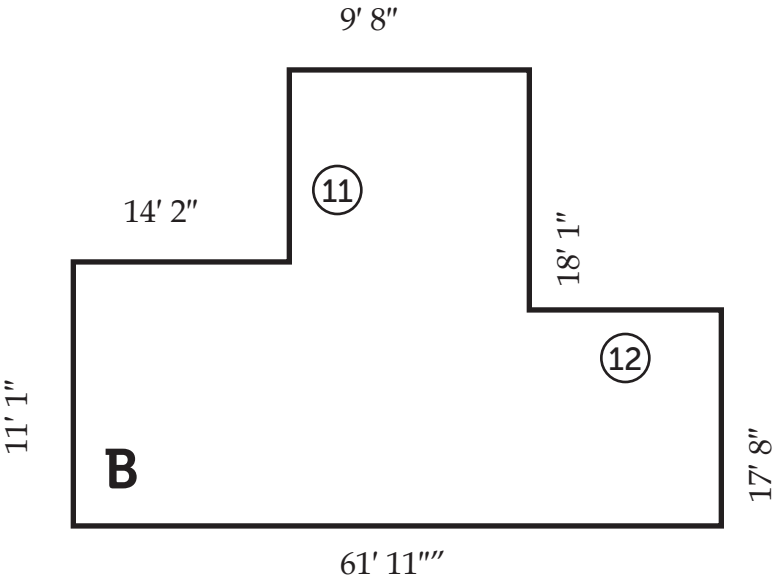
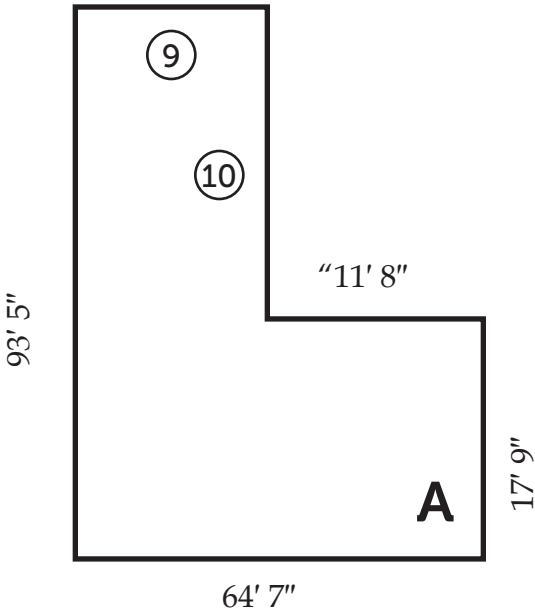

Side	Length	Side	Length	Shape	Perimeter
⑨	_____	⑪	_____	A	⑬ _____
⑩	_____	⑫	_____	B	⑭ _____

DRAWING IS NOT TO SCALE

Section III — Ruler Measurements

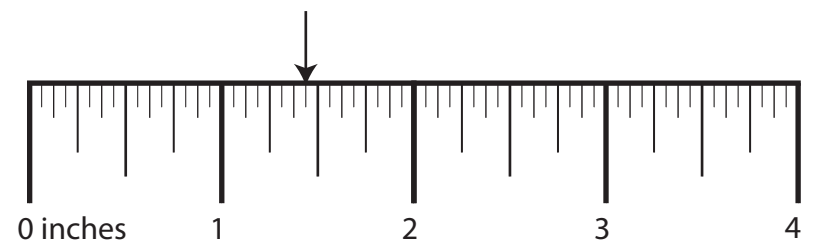
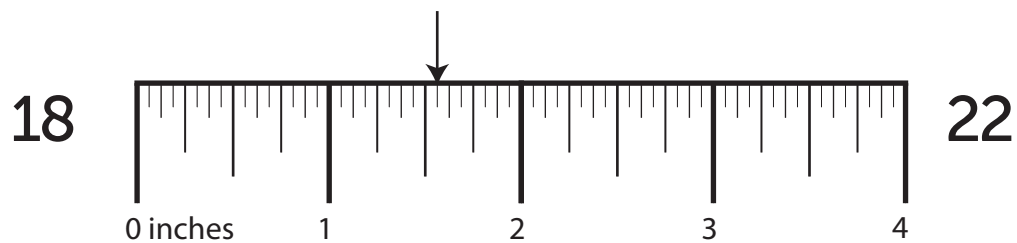
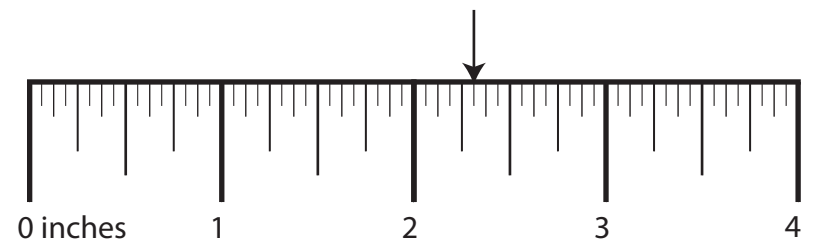
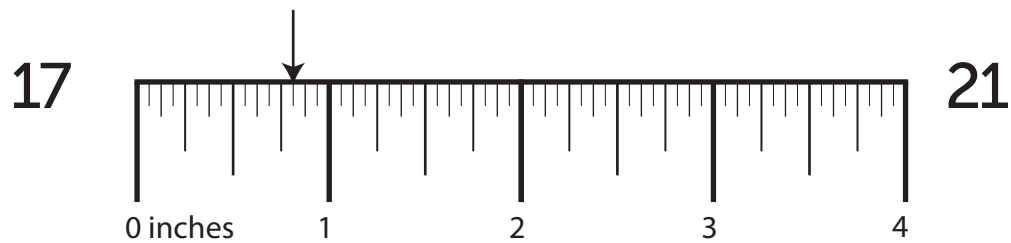
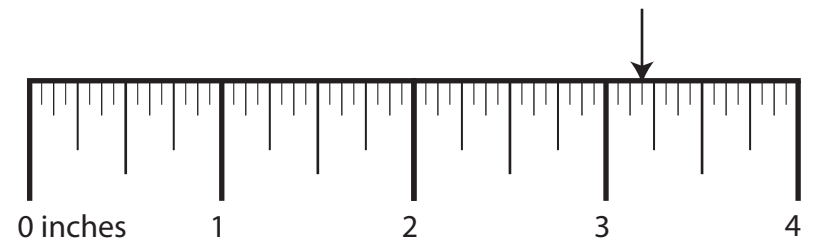
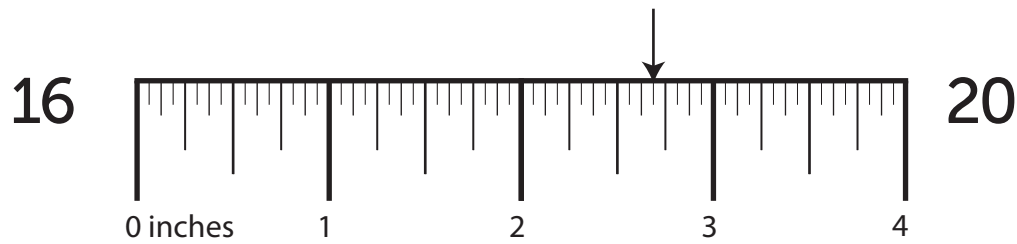
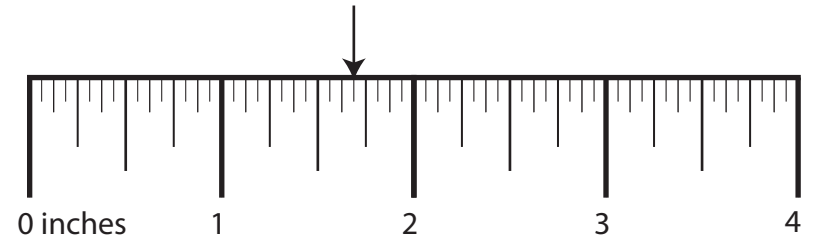
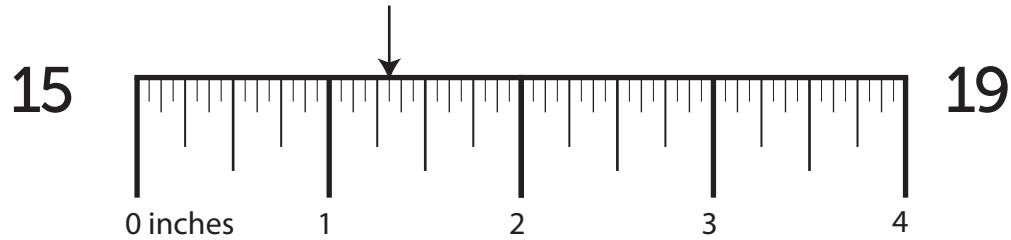

Section IV — More/Less Than

402

23. What is $\frac{5}{16}$ more than $3\frac{1}{4}$? 27. What is $\frac{5}{16}$ less than $5\frac{1}{16}$?
24. What is $\frac{1}{8}$ more than $3\frac{1}{8}$? 28. What is $\frac{5}{16}$ more than $5\frac{3}{8}$?
25. What is $\frac{3}{16}$ less than $5\frac{1}{8}$? 29. What is $\frac{1}{8}$ less than $2\frac{1}{4}$?
26. What is $\frac{3}{16}$ less than $1\frac{1}{2}$? 30. What is $\frac{1}{2}$ less than $3\frac{1}{2}$?

Section V — Nail Penetration & Screw Hole Bits

How far will a ...

What size drill bit will you need to drill a ...

31. 8 box gauge nail penetrate a 4 ½" green joist?

35. pilot hole for a 10 gauge screw?

32. 14 common gauge nail penetrate a 4" green joist?

36. clearance hole for a 11 gauge screw?

33. 10 penny nail penetrate a 5/8" dry frame?

37. pilot hole for a 11 gauge screw?

34. 6 penny nail penetrate a 3 ½" green mast?

38. clearance hole for a 6 gauge screw?