

Section I — +/– Feet & Inches

401

1. $18' 3'' - 6' 11'' =$

5. $16' 11'' - 8' 1'' =$

2. $9' 3'' - 4' 11'' =$

6. $10' 10'' + 14' 5'' =$

3. $16' 9'' + 14' 4'' =$

7. $14' 4'' + 16' 8'' =$

4. $16' 10'' + 11' 5'' =$

8. $12' 7'' + 14' 2'' =$

DRAWING IS NOT TO SCALE

401

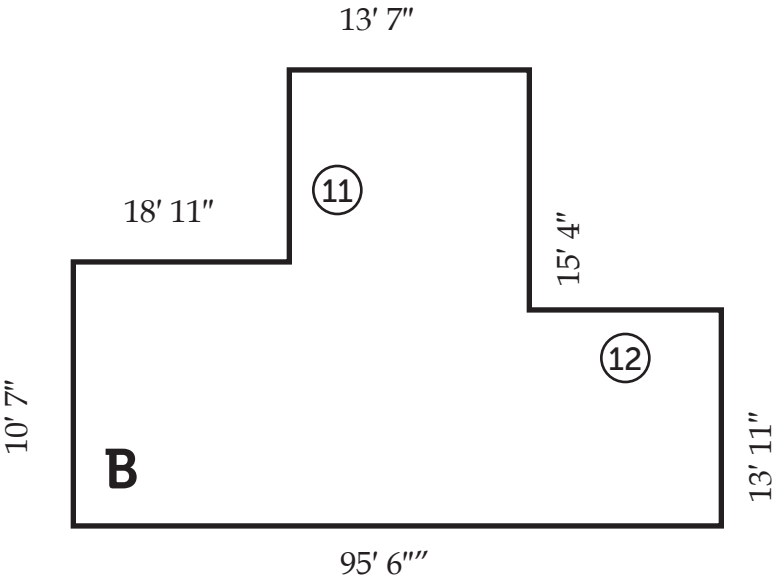
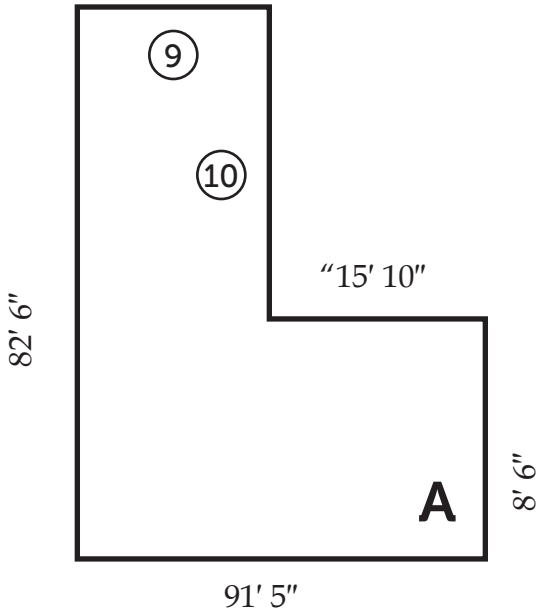

Side	Length	Side	Length	Shape	Perimeter
⑨	_____	⑪	_____	A	⑬ _____
⑩	_____	⑫	_____	B	⑭ _____

DRAWING IS NOT TO SCALE

Section III — Ruler Measurements

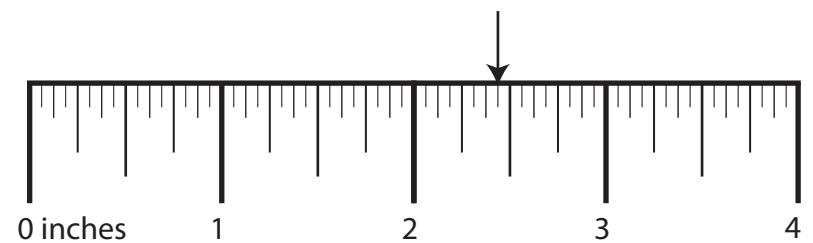
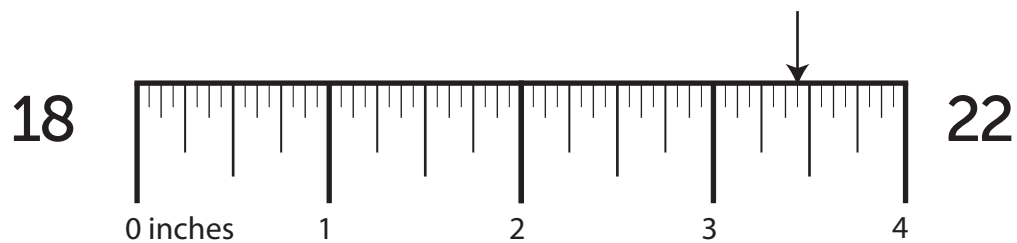
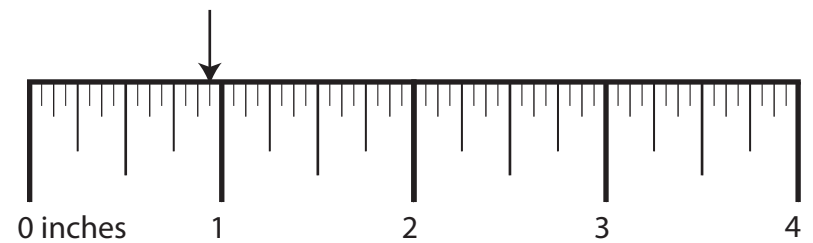
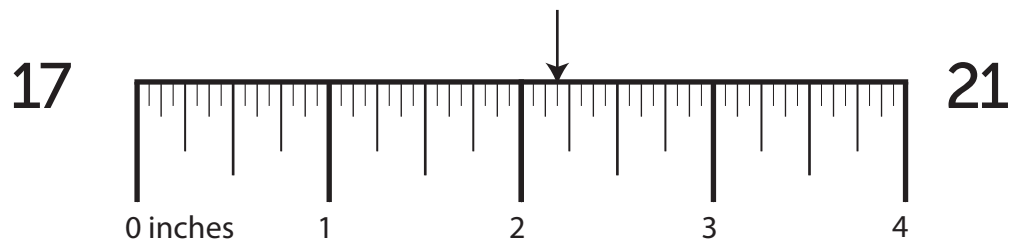
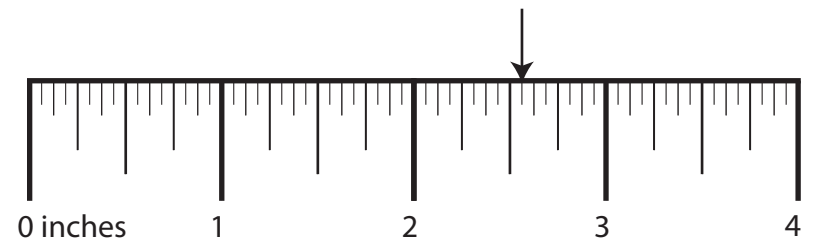
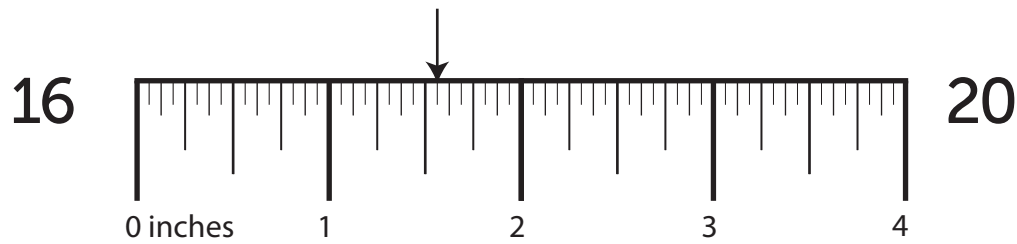
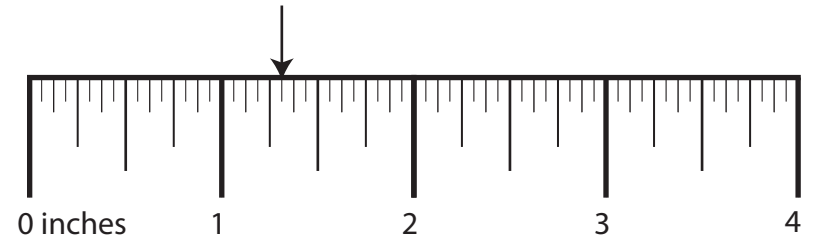
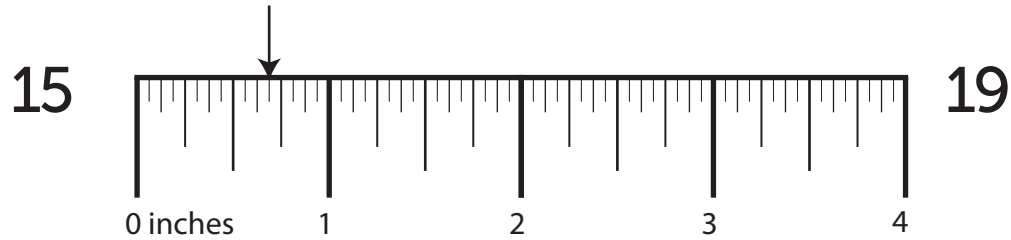

Section IV — More/Less Than

401

23. What is $\frac{1}{4}$ more than $1\frac{1}{8}$? 27. What is $\frac{1}{2}$ more than $3\frac{5}{16}$?
24. What is $\frac{1}{2}$ less than $2\frac{1}{4}$? 28. What is $\frac{3}{8}$ more than $5\frac{1}{16}$?
25. What is $\frac{5}{16}$ less than $1\frac{1}{8}$? 29. What is $\frac{1}{2}$ less than $3\frac{3}{8}$?
26. What is $\frac{1}{8}$ less than $2\frac{1}{2}$? 30. What is $\frac{1}{4}$ more than $4\frac{1}{8}$?

Section V — Nail Penetration & Screw Hole Bits

How far will a ...

What size drill bit will you need to drill a ...

31. 6 penny nail penetrate a $\frac{3}{8}$ " green pole?

35. countersink hole for a 9 gauge screw?

32. 4 penny nail penetrate a $1\frac{1}{2}$ " green girder?

36. pilot hole for a 1 gauge screw?

33. 16 penny nail penetrate a $3\frac{1}{2}$ " dry frame?

37. clearance hole for a 5 gauge screw?

34. 9 common gauge nail penetrate a $\frac{3}{8}$ " dry board?

38. countersink hole for a 24 gauge screw?