

Section I — +/– Feet & Inches

108

1. $17' 5'' - 8' 3'' =$

5. $16' 11'' - 8' 9'' =$

2. $9' 5'' - 8' 8'' =$

6. $18' 11'' - 3' 10'' =$

3. $15' 11'' - 8' 8'' =$

7. $18' 4'' + 15' 9'' =$

4. $16' 7'' - 11' 3'' =$

8. $13' 4'' - 6' 3'' =$

DRAWING IS NOT TO SCALE

108

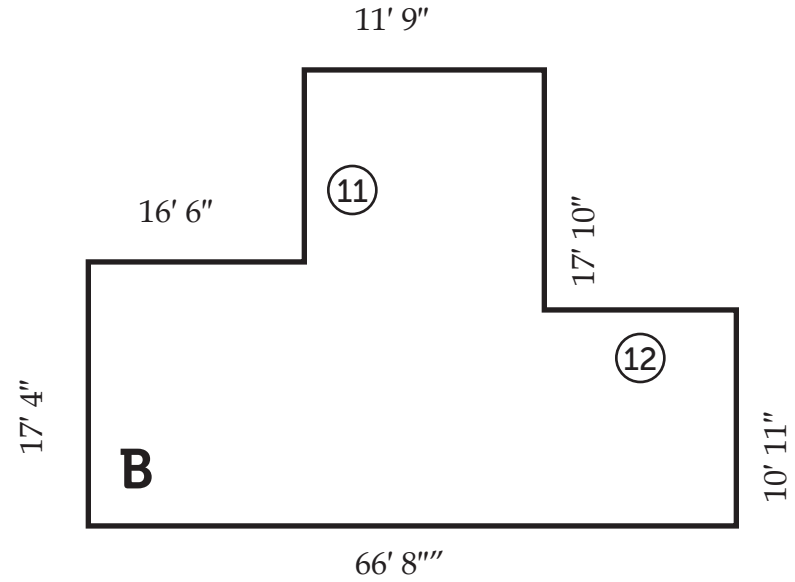
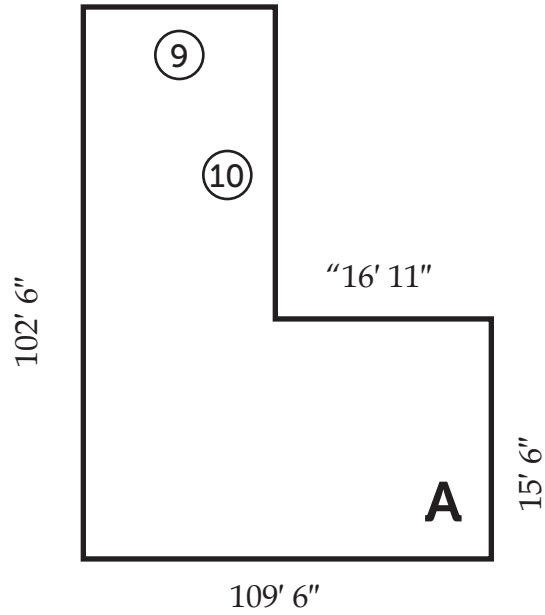

Side	Length	Side	Length	Shape	Perimeter
⑨	_____	⑪	_____	A	⑬ _____
⑩	_____	⑫	_____	B	⑭ _____

DRAWING IS NOT TO SCALE

Section III – Ruler Measurements

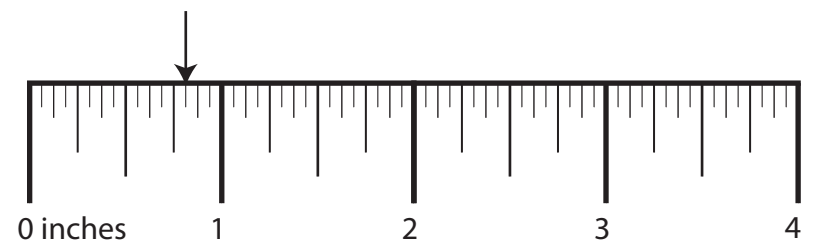
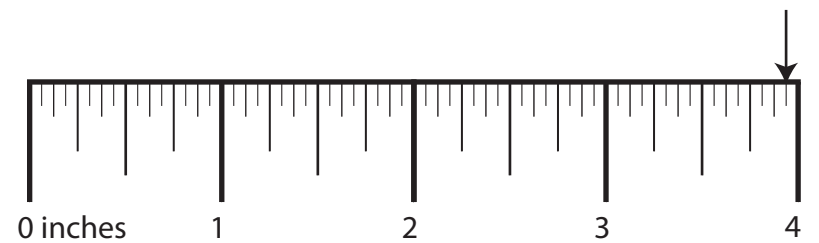
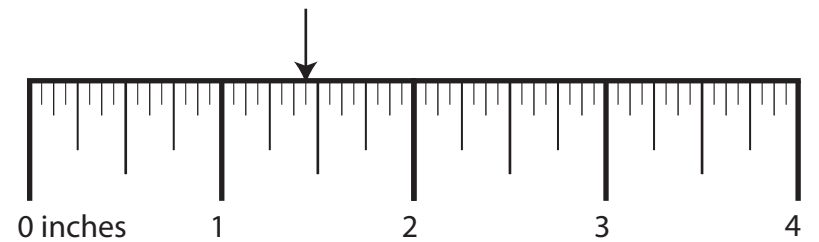
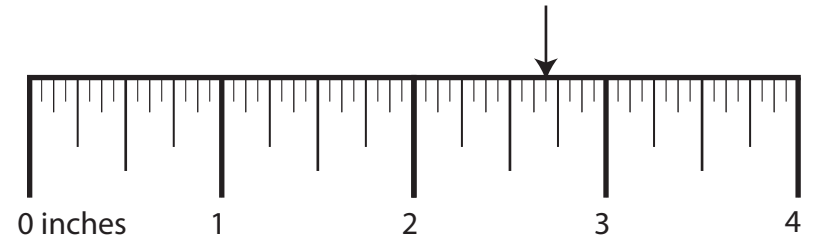
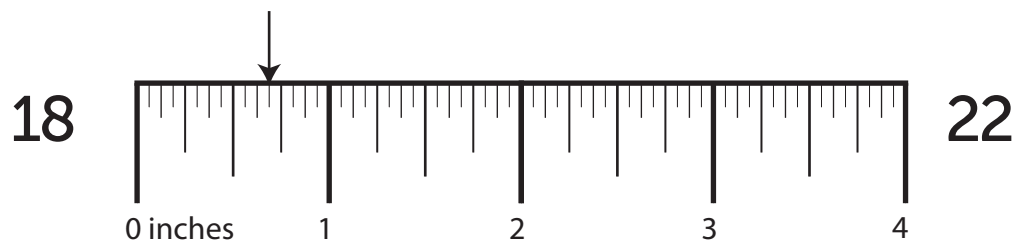
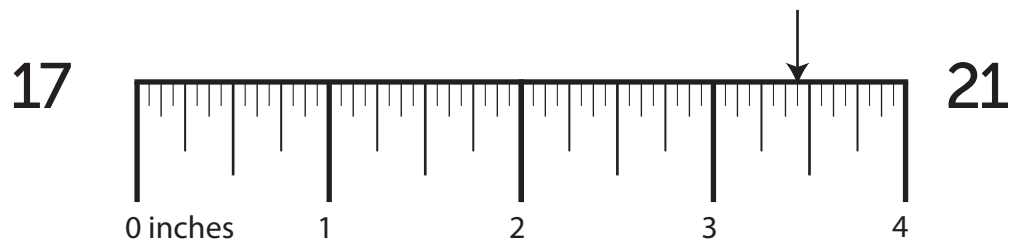
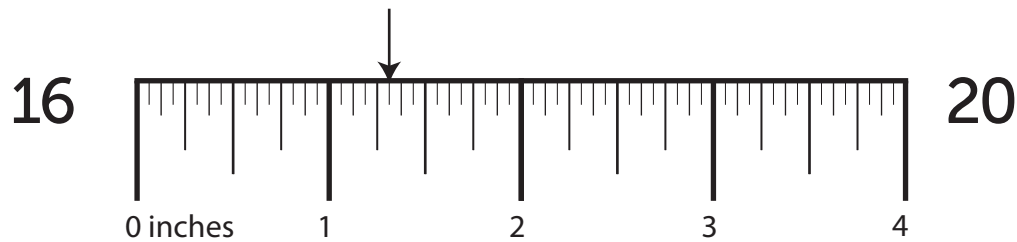
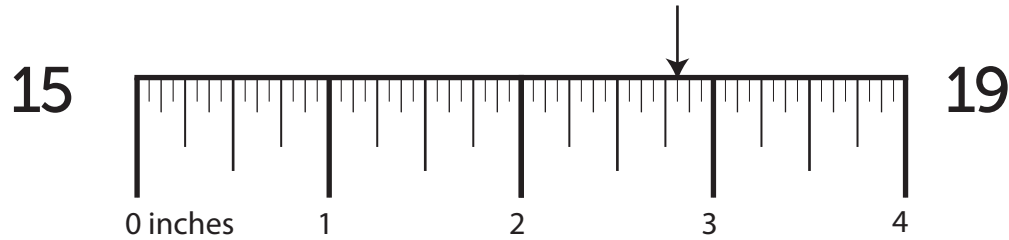

Section IV — More/Less Than

108

23. What is $\frac{1}{8}$ more than $2\frac{3}{8}$? 27. What is $\frac{5}{16}$ more than $5\frac{1}{2}$?
24. What is $\frac{1}{4}$ less than $1\frac{1}{2}$? 28. What is $\frac{1}{2}$ more than $4\frac{5}{16}$?
25. What is $\frac{1}{4}$ more than $5\frac{1}{4}$? 29. What is $\frac{5}{16}$ less than $3\frac{3}{16}$?
26. What is $\frac{1}{2}$ less than $1\frac{5}{16}$? 30. What is $\frac{1}{8}$ more than $5\frac{3}{16}$?

Section V – Nail Penetration & Screw Hole Bits

How far will a ...

What size drill bit will you need to drill a ...

31. 14 common gauge nail penetrate a 4 ½" green rafter? 35. clearance hole for a 16 gauge screw?

32. 15 ½ box gauge nail penetrate a ½" dry timber? 36. countersink hole for a 4 gauge screw?

33. 7 penny nail penetrate a 2" dry rafter? 37. clearance hole for a 16 gauge screw?

34. 4 penny nail penetrate a 3/8" green plank? 38. countersink hole for a 12 gauge screw?