

Section I — +/- Feet & Inches

107

1. $9' 10'' - 9' 7'' =$

5. $17' 9'' - 9' 5'' =$

2. $10' 6'' + 9' 3'' =$

6. $12' 2'' - 1' 9'' =$

3. $11' 9'' - 1' 5'' =$

7. $10' 11'' + 9' 1'' =$

4. $13' 10'' - 4' 10'' =$

8. $10' 3'' + 9' 11'' =$

DRAWING IS NOT TO SCALE

107

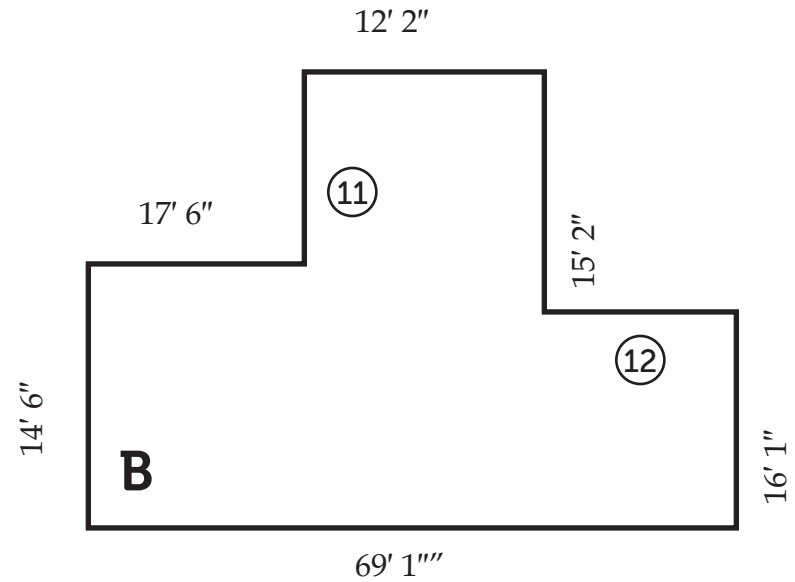
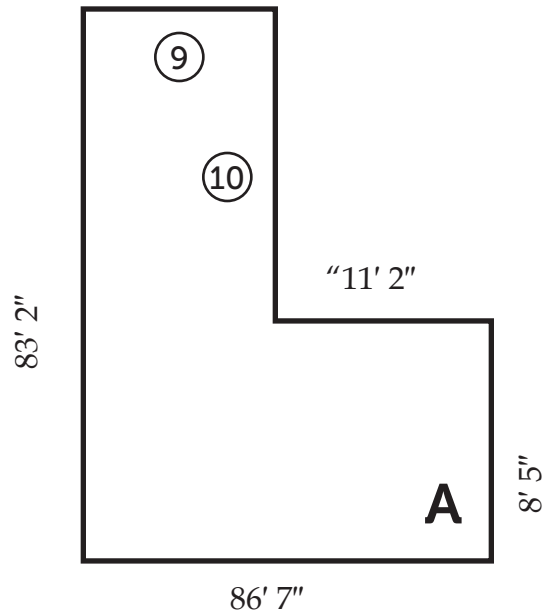

| Side | Length | Side | Length | Shape | Perimeter |
|------|--------|------|--------|-------|-----------|
| ⑨ | _____ | ⑪ | _____ | A | ⑬ _____ |
| ⑩ | _____ | ⑫ | _____ | B | ⑭ _____ |

DRAWING IS NOT TO SCALE

Section III – Ruler Measurements

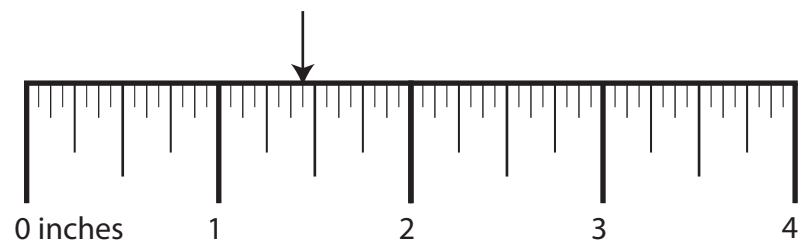
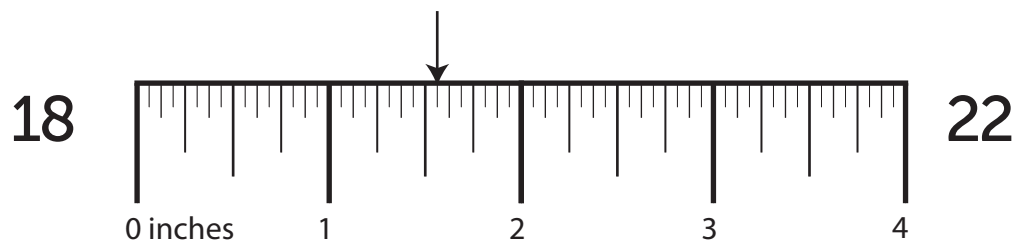
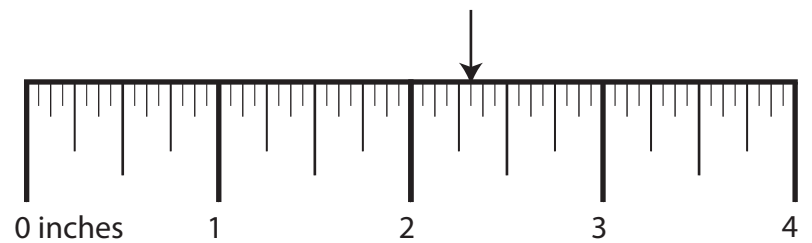
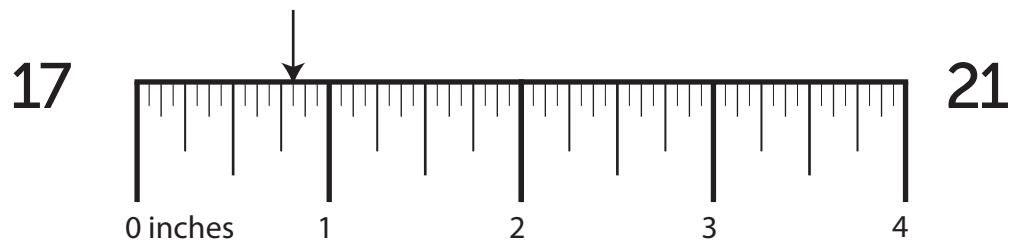
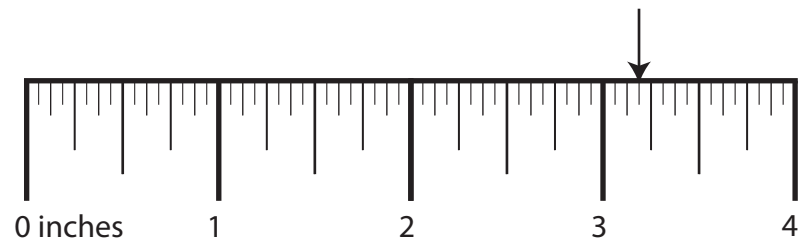
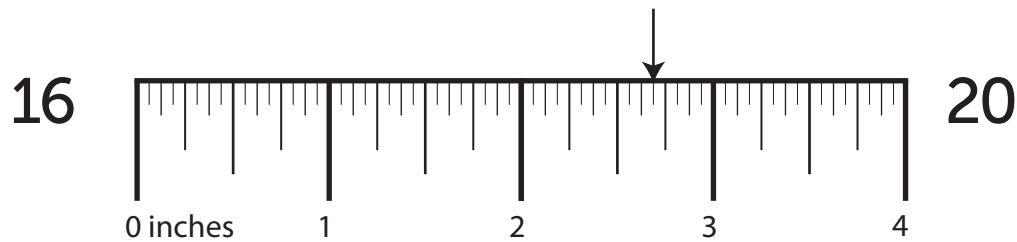
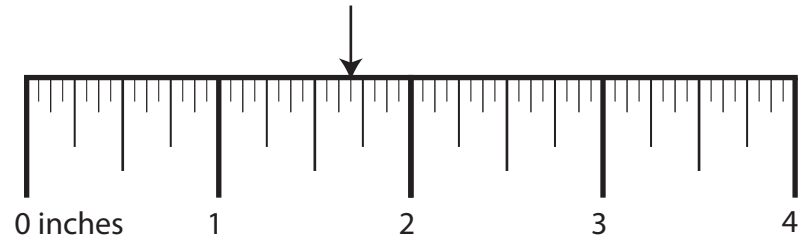
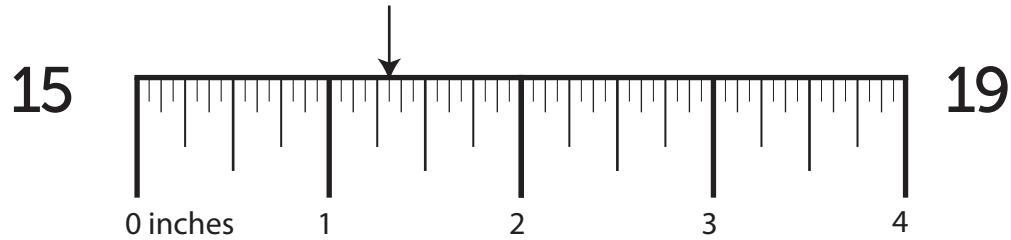

Section IV – More/Less Than

107

23. What is $\frac{5}{16}$ less than $4 \frac{1}{8}$? 27. What is $\frac{1}{2}$ less than $2 \frac{1}{4}$?
24. What is $\frac{1}{2}$ less than $2 \frac{1}{4}$? 28. What is $\frac{1}{4}$ less than $4 \frac{3}{8}$?
25. What is $\frac{5}{16}$ less than $1 \frac{1}{2}$? 29. What is $\frac{5}{16}$ less than $5 \frac{1}{4}$?
26. What is $\frac{1}{2}$ less than $5 \frac{1}{2}$? 30. What is $\frac{1}{4}$ more than $4 \frac{1}{8}$?

Section V – Nail Penetration & Screw Hole Bits

How far will a ...

What size drill bit will you need to drill a ...

31. 11 ½ common gauge nail penetrate a ¾" dry rafter? 35. clearance hole for a 4 gauge screw?

32. 2 common gauge nail penetrate a 2 ½" dry board? 36. pilot hole for a 18 gauge screw?

33. 10 penny nail penetrate a 2" green rafter? 37. clearance hole for a 18 gauge screw?

34. 9 common gauge nail penetrate a 3 ½" green beam? 38. pilot hole for a 8 gauge screw?