

Section I — +/– Feet & Inches

106

1. $18' 11'' - 10' 9'' =$

5. $15' 10'' + 9' 6'' =$

2. $9' 3'' - 4' 6'' =$

6. $16' 3'' + 8' 6'' =$

3. $17' 3'' + 12' 5'' =$

7. $18' 11'' - 6' 6'' =$

4. $11' 2'' - 2' 1'' =$

8. $15' 2'' - 9' 4'' =$

DRAWING IS NOT TO SCALE

106

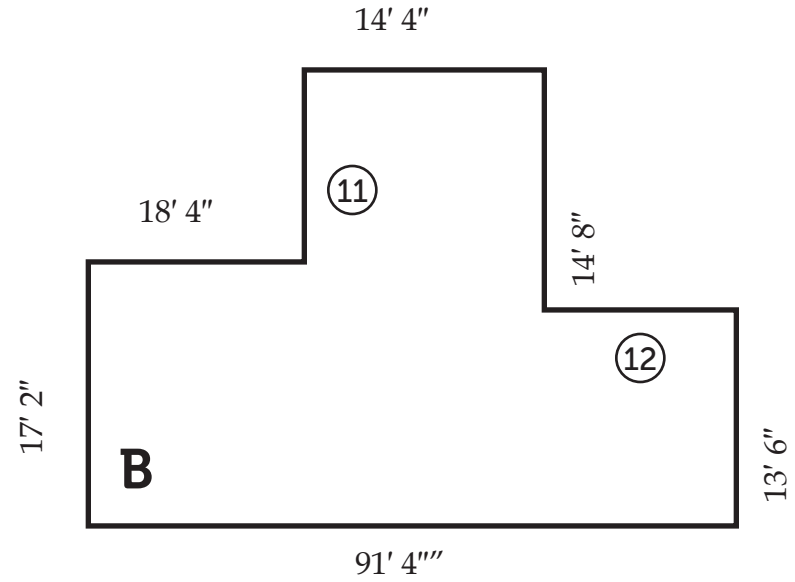
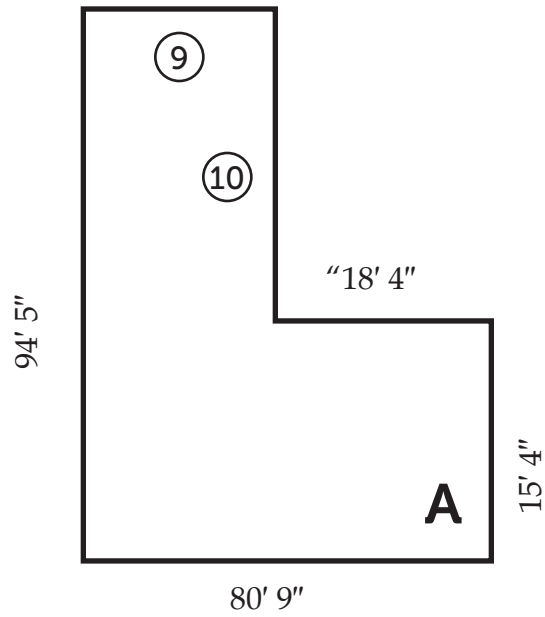

Side	Length	Side	Length	Shape	Perimeter
⑨	_____	⑪	_____	A	⑬ _____
⑩	_____	⑫	_____	B	⑭ _____

DRAWING IS NOT TO SCALE

Section III – Ruler Measurements

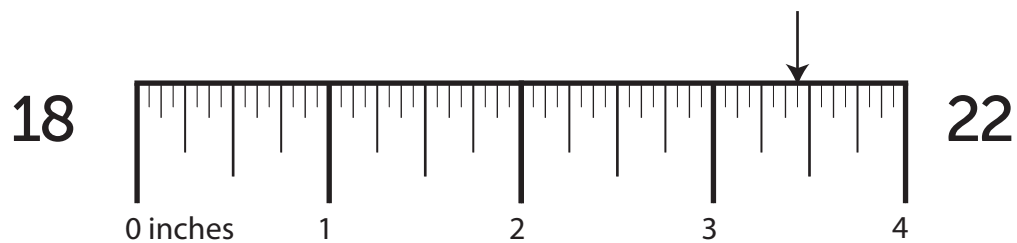
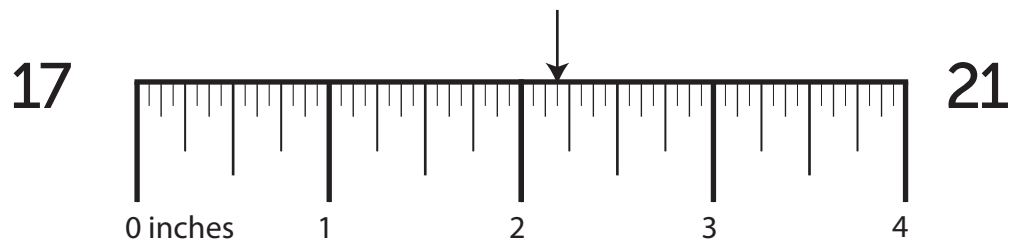
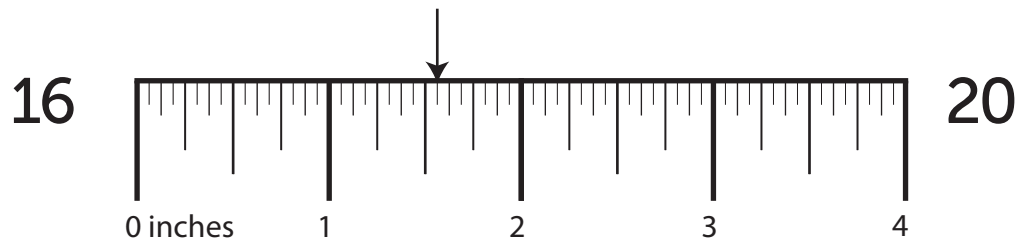
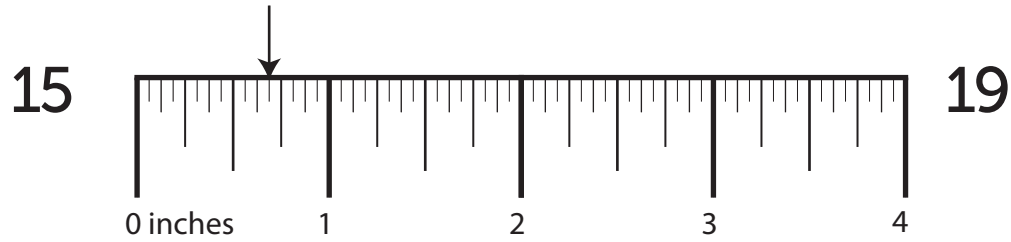

Section IV — More/Less Than

106

23. What is $\frac{1}{8}$ more than $5 \frac{1}{4}$? 27. What is $\frac{3}{16}$ less than $1 \frac{1}{4}$?
24. What is $\frac{1}{8}$ less than $5 \frac{3}{16}$? 28. What is $\frac{5}{16}$ less than $4 \frac{1}{16}$?
25. What is $\frac{1}{8}$ more than $3 \frac{1}{4}$? 29. What is $\frac{5}{16}$ less than $3 \frac{3}{8}$?
26. What is $\frac{5}{16}$ less than $5 \frac{1}{2}$? 30. What is $\frac{1}{4}$ more than $4 \frac{1}{8}$?

Section V – Nail Penetration & Screw Hole Bits

How far will a ...

What size drill bit will you need to drill a ...

31. 10 ½ box gauge nail penetrate a 1 ½" green joist?

35. countersink hole for a 24 gauge screw?

32. 11 ½ box gauge nail penetrate a 4" green mast?

36. clearance hole for a 2 gauge screw?

33. 2 penny nail penetrate a 4 ½" green girder?

37. pilot hole for a 20 gauge screw?

34. 9 box gauge nail penetrate a ½" dry frame?

38. clearance hole for a 6 gauge screw?