

## Section I — +/– Feet &amp; Inches

**104**

---

1.  $14' 9'' + 15' 2'' =$

5.  $8' 7'' + 17' 7'' =$

2.  $11' 10'' + 16' 9'' =$

6.  $17' 8'' + 8' 3'' =$

3.  $11' 8'' - 9' 9'' =$

7.  $8' 8'' + 11' 8'' =$

4.  $14' 3'' - 9' 1'' =$

8.  $15' 3'' + 18' 4'' =$

DRAWING IS NOT TO SCALE

# 104

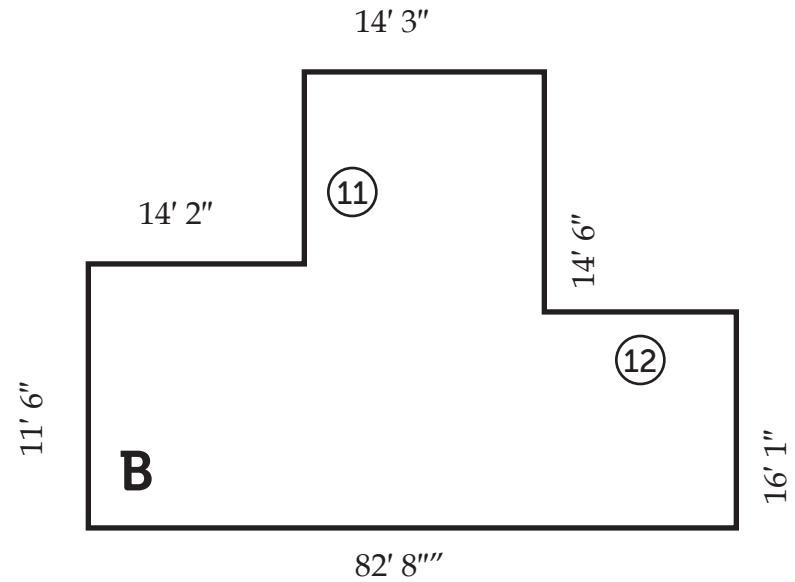
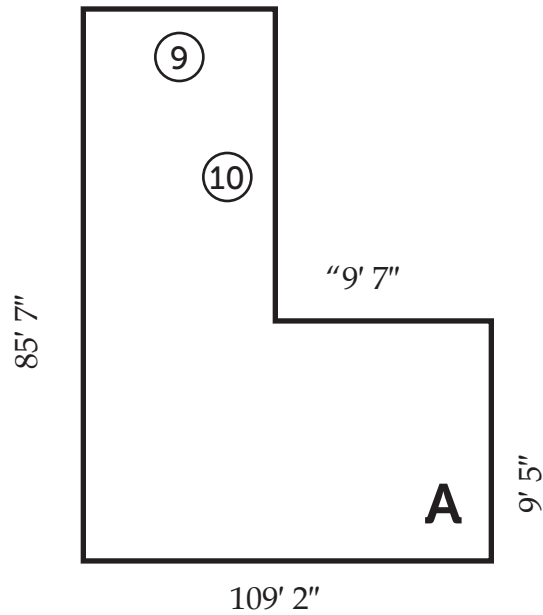

Side	Length	Side	Length	Shape	Perimeter
⑨	_____	⑪	_____	A	⑬ _____
⑩	_____	⑫	_____	B	⑭ _____

# DRAWING IS NOT TO SCALE

## Section III – Ruler Measurements

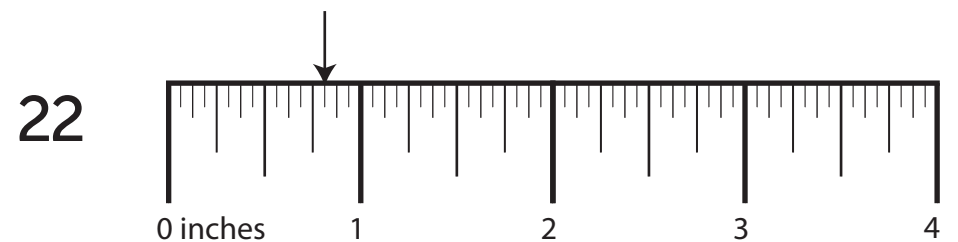
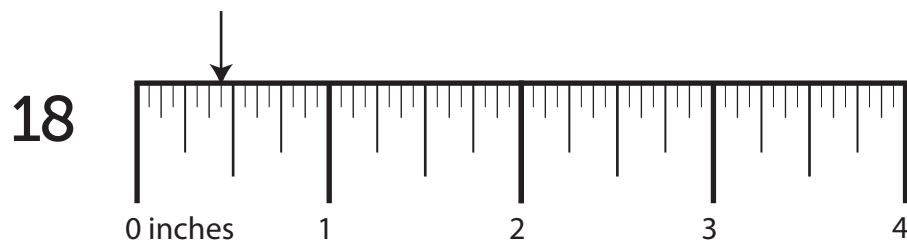
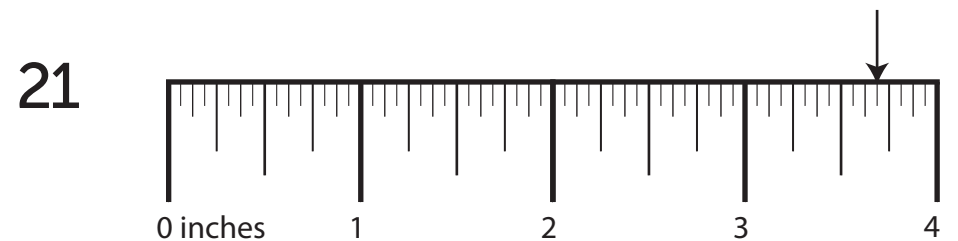
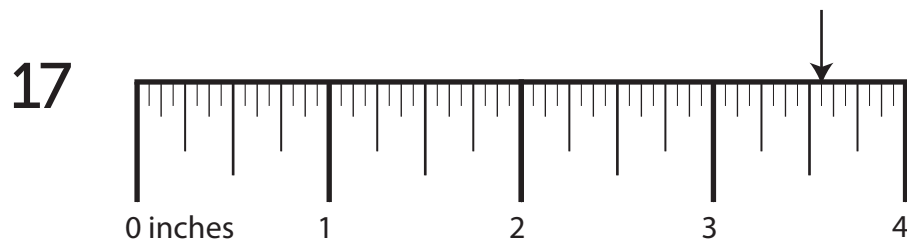
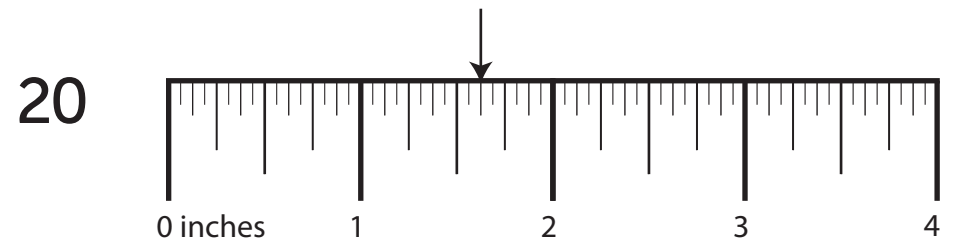
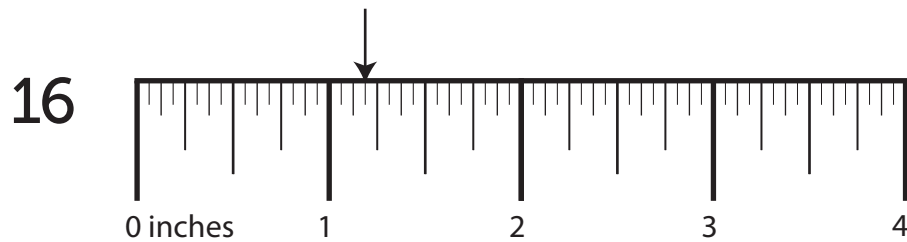
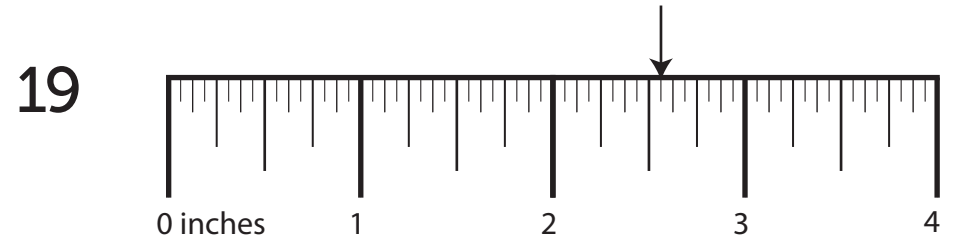
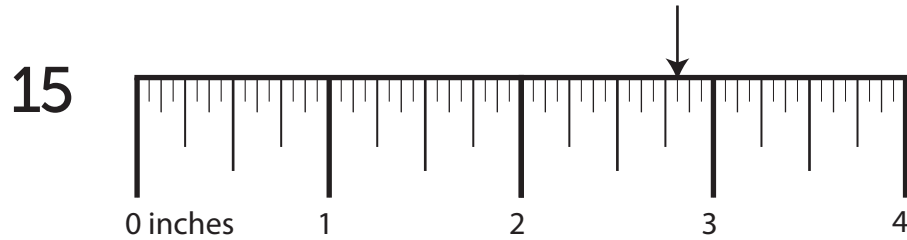

## Section IV – More/Less Than

**104**

---

23. What is  $\frac{1}{2}$  more than  $5\frac{1}{4}$ ?      27. What is  $\frac{3}{8}$  more than  $2\frac{5}{16}$ ?
24. What is  $\frac{1}{2}$  more than  $5\frac{5}{16}$ ?      28. What is  $\frac{3}{16}$  more than  $1\frac{1}{4}$ ?
25. What is  $\frac{1}{8}$  less than  $1\frac{1}{4}$ ?      29. What is  $\frac{1}{16}$  more than  $2\frac{1}{8}$ ?
26. What is  $\frac{3}{8}$  more than  $4\frac{3}{16}$ ?      30. What is  $\frac{3}{16}$  more than  $3\frac{3}{16}$ ?

## Section V — Nail Penetration & Screw Hole Bits

How far will a ...

What size drill bit will you need to drill a ...

31. 30 penny nail penetrate a 1" green mast?

35. pilot hole for a 20 gauge screw?

32. 10 ½ box gauge nail penetrate a 1" dry pole?

36. pilot hole for a 3 gauge screw?

33. 30 penny nail penetrate a 2" dry plank?

37. countersink hole for a 7 gauge screw?

34. 20 penny nail penetrate a 5/8" dry joist?

38. pilot hole for a 20 gauge screw?