

Section I – +/– Feet & Inches

219

1. $12' 7'' + 14' 11'' =$

5. $10' 5'' - 3' 2'' =$

2. $10' 4'' - 9' 5'' =$

6. $16' 2'' - 3' 9'' =$

3. $8' 7'' - 8' 1'' =$

7. $17' 4'' - 3' 11'' =$

4. $17' 11'' + 17' 1'' =$

8. $12' 6'' + 10' 10'' =$

DRAWING IS NOT TO SCALE

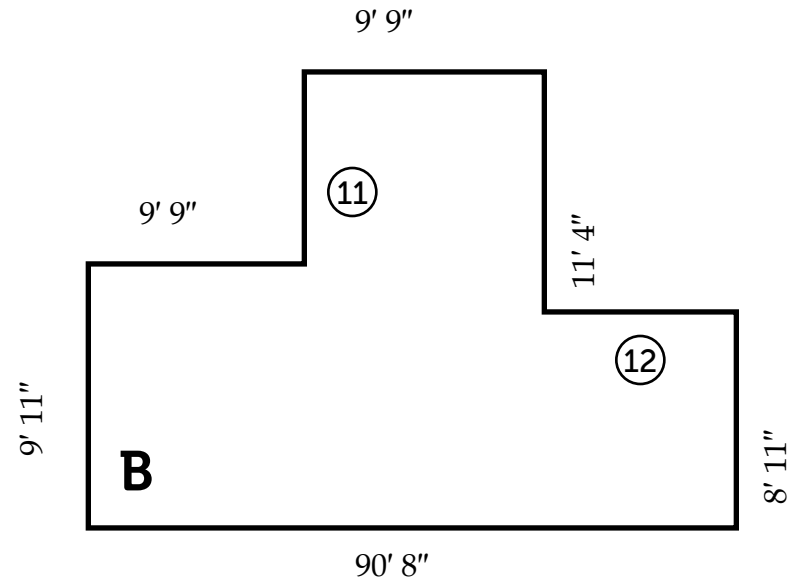
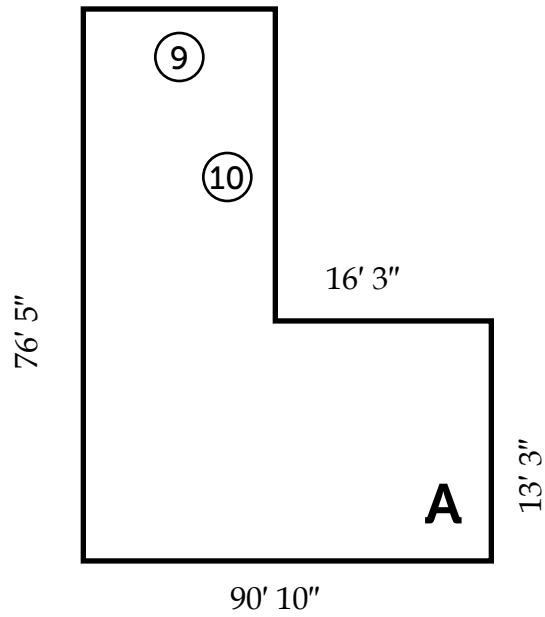

Side	Length	Side	Length	Shape	Perimeter
⑨	_____	⑪	_____	A	⑬ _____
⑩	_____	⑫	_____	B	⑭ _____

DRAWING IS NOT TO SCALE

Section III – Ruler Measurements

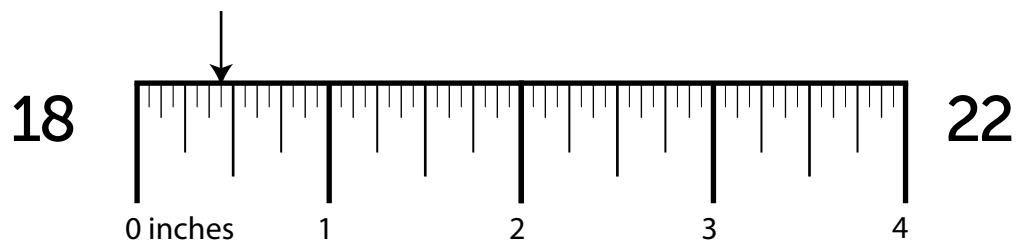
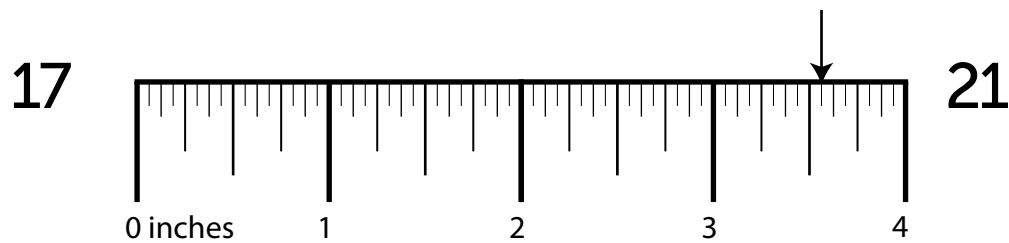
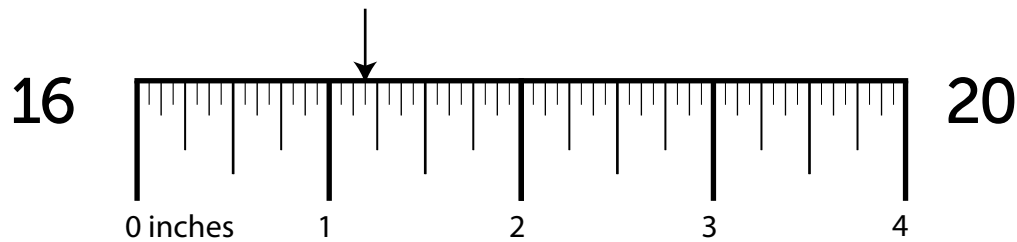
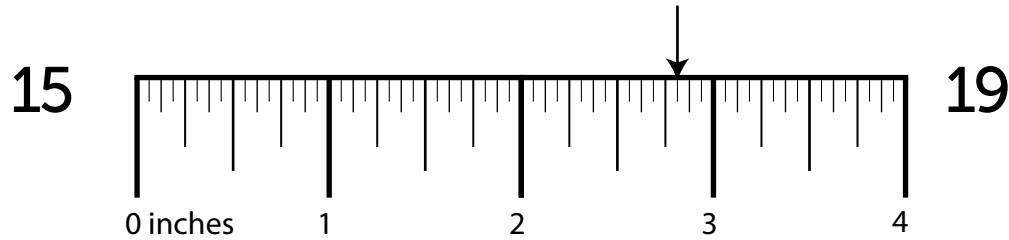

Section IV — More/Less Than

23. What is $\frac{1}{4}$ less than $1 \frac{1}{4}$?

27. What is $\frac{1}{4}$ less than $1 \frac{1}{4}$?

24. What is $\frac{1}{8}$ less than $4 \frac{1}{4}$?

28. What is $\frac{3}{16}$ more than $3 \frac{1}{4}$?

25. What is $\frac{1}{8}$ less than $4 \frac{1}{16}$?

29. What is $\frac{1}{8}$ more than $1 \frac{1}{4}$?

26. What is $\frac{1}{2}$ less than $3 \frac{3}{8}$?

30. What is $\frac{3}{8}$ more than $4 \frac{3}{8}$?

Section V – Nail Penetration & Screw Hole Bits

How far will a ...

What size drill bit will you need to drill a ...

31. 5 penny nail penetrate a 3" dry plank?

35. pilot hole for a 3 gauge screw?

32. 8 common gauge nail penetrate a 2" dry plank?

36. clearance hole for a 7 gauge screw?

33. 15 ½ box gauge nail penetrate a ½" green rafter?

37. pilot hole for a 20 gauge screw?

34. 50 penny nail penetrate a 1 ¼" dry frame?

38. countersink hole for a 18 gauge screw?