

## Section I — +/− Feet &amp; Inches

**216**

---

1.  $14' 11'' - 6' 2'' =$

5.  $18' 1'' - 1' 3'' =$

2.  $14' 4'' - 9' 4'' =$

6.  $14' 7'' + 17' 7'' =$

3.  $10' 5'' - 5' 1'' =$

7.  $11' 5'' + 18' 8'' =$

4.  $12' 5'' + 14' 1'' =$

8.  $12' 4'' + 10' 4'' =$

**DRAWING IS NOT TO SCALE**

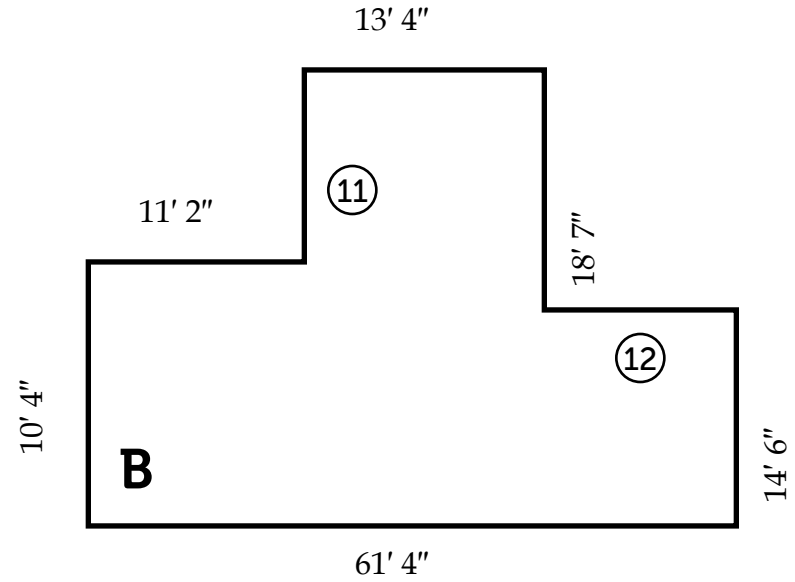
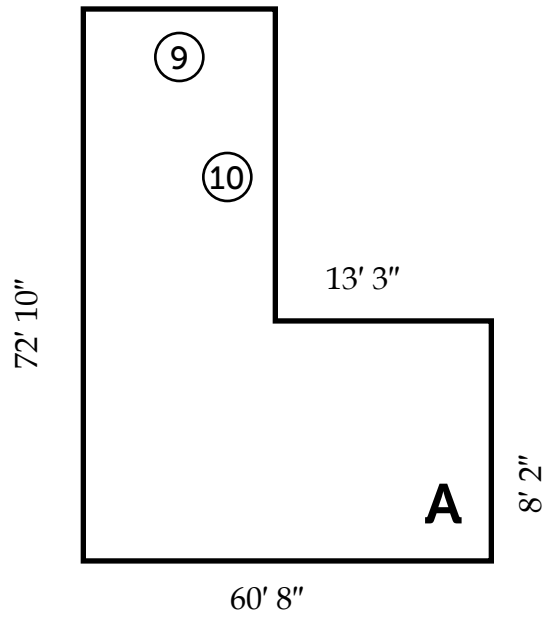

Side	Length	Side	Length	Shape	Perimeter
⑨	_____	⑪	_____	A	⑬ _____
⑩	_____	⑫	_____	B	⑭ _____

# DRAWING IS NOT TO SCALE

## Section III – Ruler Measurements

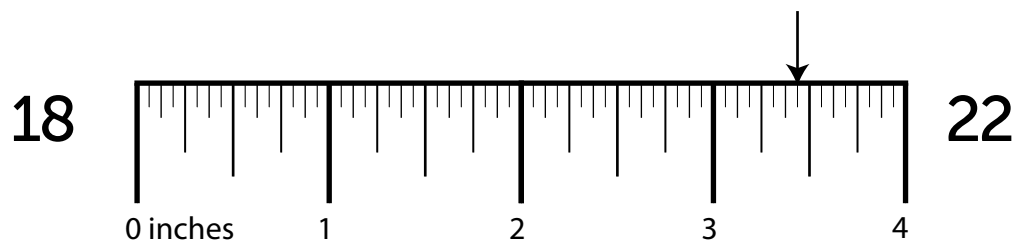
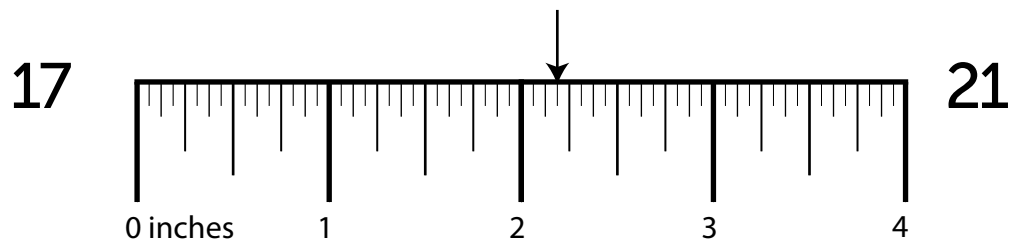
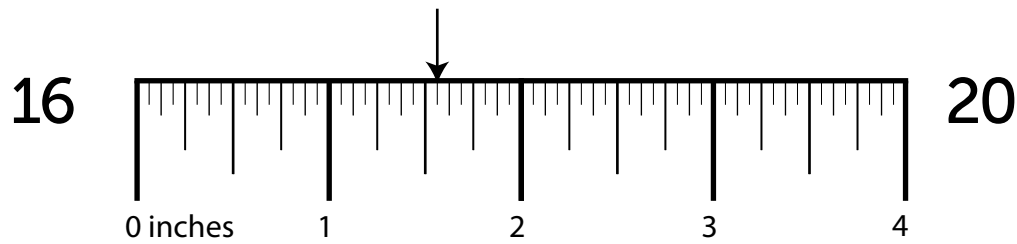
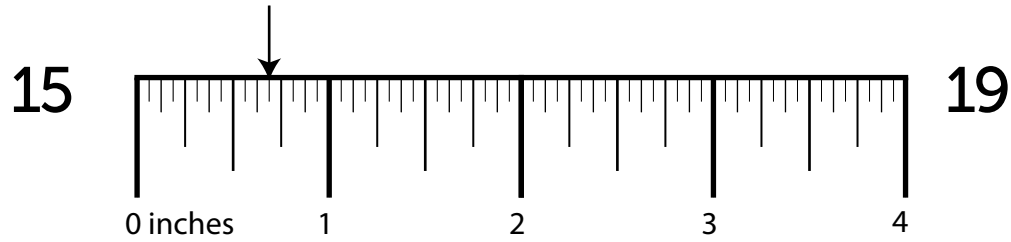

## Section IV — More/Less Than

23. What is  $\frac{1}{4}$  less than  $3\frac{3}{16}$ ?

27. What is  $\frac{3}{16}$  more than  $1\frac{1}{4}$ ?

24. What is  $\frac{1}{2}$  less than  $2\frac{1}{4}$ ?

28. What is  $\frac{1}{16}$  less than  $2\frac{1}{2}$ ?

25. What is  $\frac{3}{16}$  less than  $3\frac{1}{2}$ ?

29. What is  $\frac{1}{2}$  more than  $1\frac{1}{16}$ ?

26. What is  $\frac{1}{4}$  less than  $2\frac{3}{16}$ ?

30. What is  $\frac{1}{4}$  less than  $1\frac{3}{8}$ ?

## Section V — Nail Penetration & Screw Hole Bits

How far will a ...

What size drill bit will you need to drill a ...

31. 4 common gauge nail penetrate a  $\frac{3}{4}$ " green dimension?
32. 2 common gauge nail penetrate a  $\frac{3}{8}$ " dry joist?
33. 5 common gauge nail penetrate a 3" dry mast?
34. 16 penny nail penetrate a  $3\frac{1}{2}$ " green frame?
35. pilot hole for a 3 gauge screw?
36. pilot hole for a 16 gauge screw?
37. pilot hole for a 4 gauge screw?
38. clearance hole for a 14 gauge screw?