

## Section I – +/– Feet &amp; Inches

**215**

---

1.  $17' 6'' - 9' 7'' =$

5.  $10' 10'' - 1' 3'' =$

2.  $12' 4'' + 11' 4'' =$

6.  $15' 2'' - 4' 1'' =$

3.  $9' 11'' - 4' 5'' =$

7.  $12' 5'' - 8' 5'' =$

4.  $13' 8'' - 1' 10'' =$

8.  $11' 2'' - 8' 1'' =$

**DRAWING IS NOT TO SCALE**

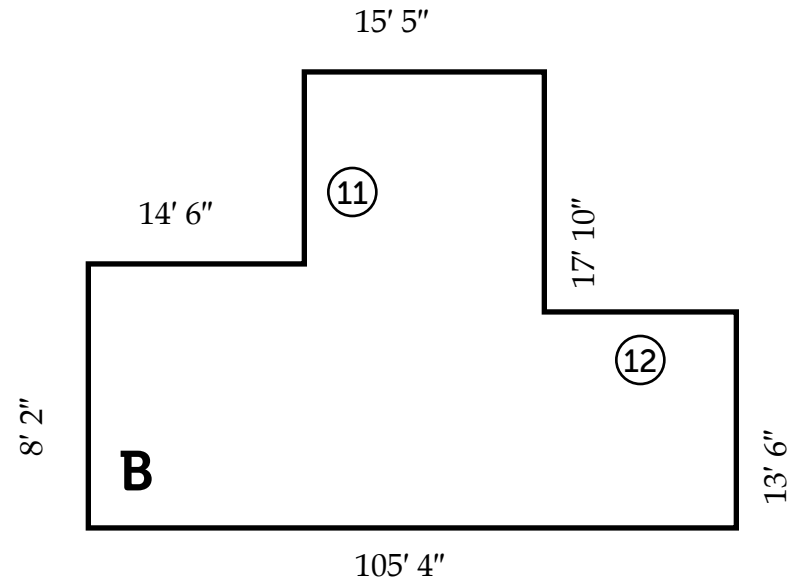
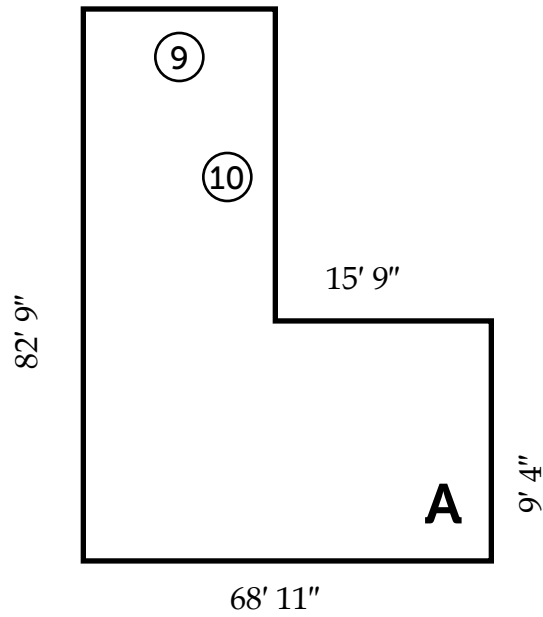

Side	Length	Side	Length	Shape	Perimeter
⑨	_____	⑪	_____	A	⑬ _____
⑩	_____	⑫	_____	B	⑭ _____

# DRAWING IS NOT TO SCALE

## Section III – Ruler Measurements

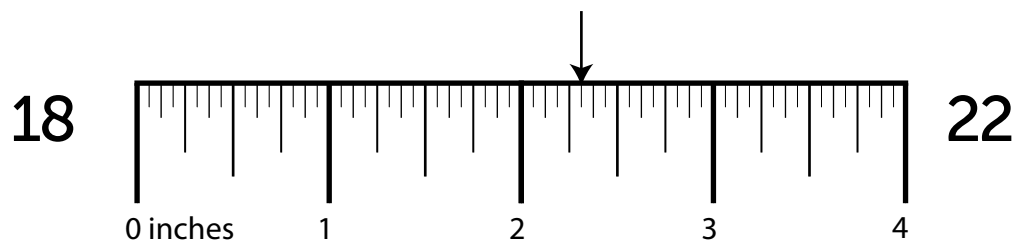
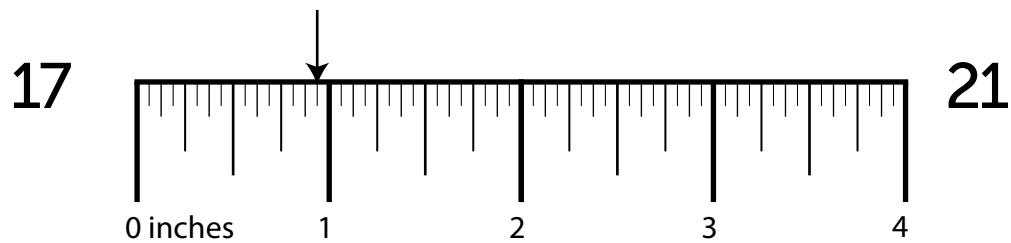
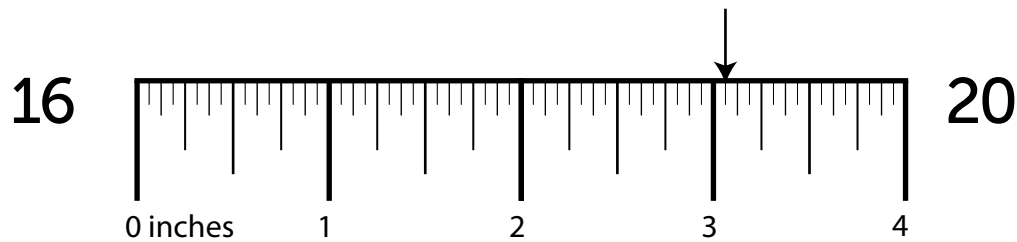
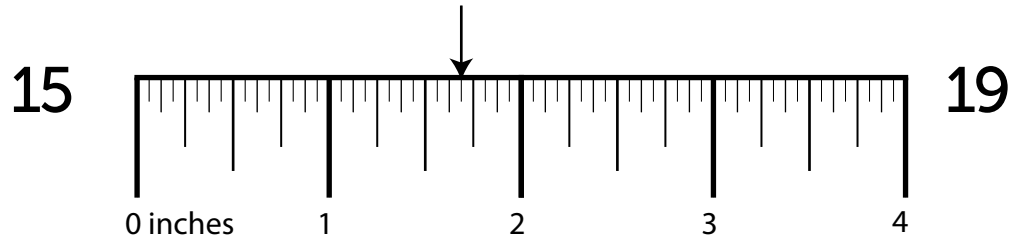

## Section IV — More/Less Than

23. What is  $\frac{1}{2}$  more than  $1\frac{5}{16}$ ?      27. What is  $\frac{1}{8}$  more than  $1\frac{3}{8}$ ?

24. What is  $\frac{3}{8}$  less than  $5\frac{3}{8}$ ?      28. What is  $\frac{1}{2}$  less than  $2\frac{1}{8}$ ?

25. What is  $\frac{1}{2}$  less than  $3\frac{5}{16}$ ?      29. What is  $\frac{5}{16}$  less than  $1\frac{1}{2}$ ?

26. What is  $\frac{3}{8}$  more than  $3\frac{1}{4}$ ?      30. What is  $\frac{5}{16}$  more than  $4\frac{1}{8}$ ?

## Section V – Nail Penetration & Screw Hole Bits

How far will a ...

What size drill bit will you need to drill a ...

31. 10 penny nail penetrate a 1" dry timber?
32. 4 common gauge nail penetrate a 2" green board?
33. 15 ½ box gauge nail penetrate a 1 ¼" dry frame?
34. 30 penny nail penetrate a 4" green mast?
35. countersink hole for a 7 gauge screw?
36. pilot hole for a 18 gauge screw?
37. countersink hole for a 1 gauge screw?
38. clearance hole for a 4 gauge screw?