

Section I – +/– Feet & Inches

214

1. $8' 1'' + 11' 8'' =$

5. $8' 4'' - 2' 4'' =$

2. $16' 1'' + 13' 11'' =$

6. $13' 3'' - 7' 7'' =$

3. $14' 8'' - 5' 10'' =$

7. $18' 5'' + 15' 2'' =$

4. $18' 11'' - 1' 10'' =$

8. $10' 3'' + 13' 3'' =$

DRAWING IS NOT TO SCALE

215

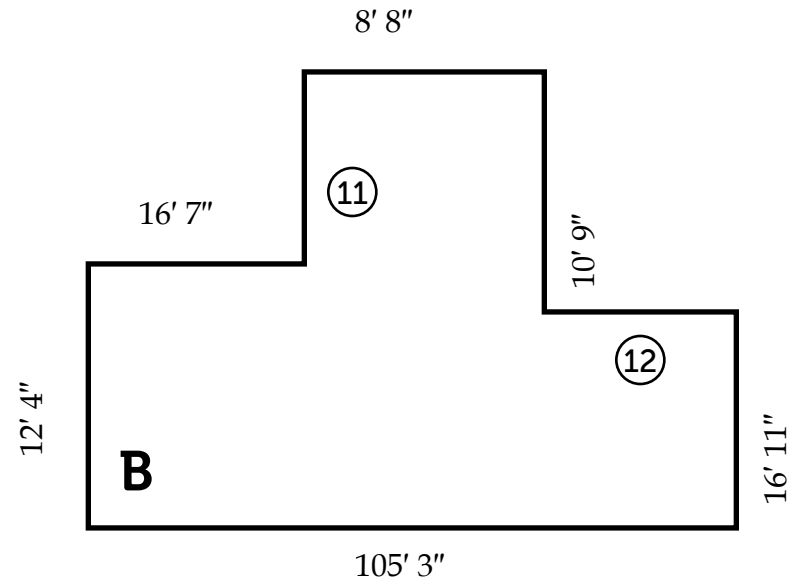
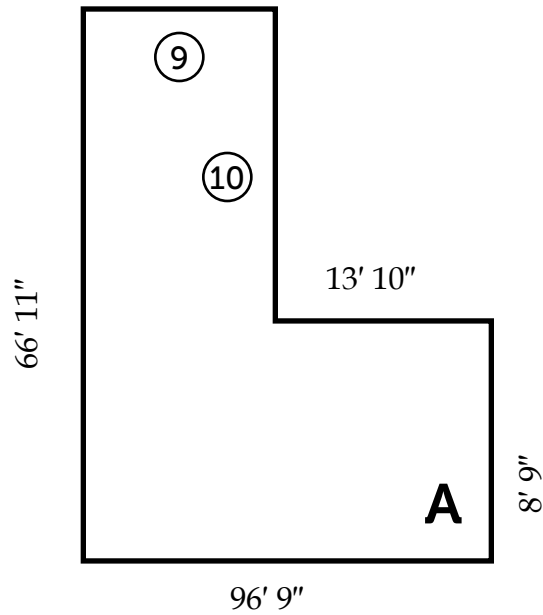

Side	Length	Side	Length	Shape	Perimeter
⑨	_____	⑪	_____	A	⑬ _____
⑩	_____	⑫	_____	B	⑭ _____

DRAWING IS NOT TO SCALE

Section III – Ruler Measurements

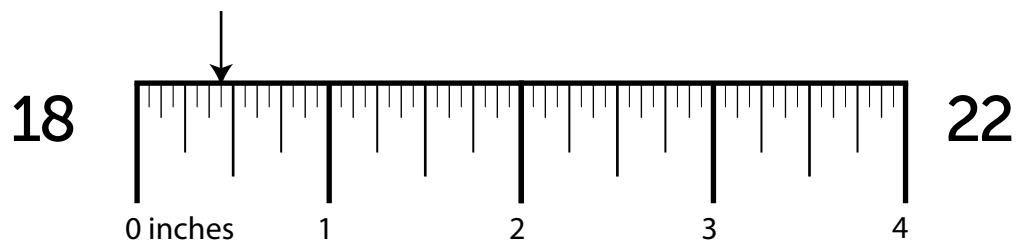
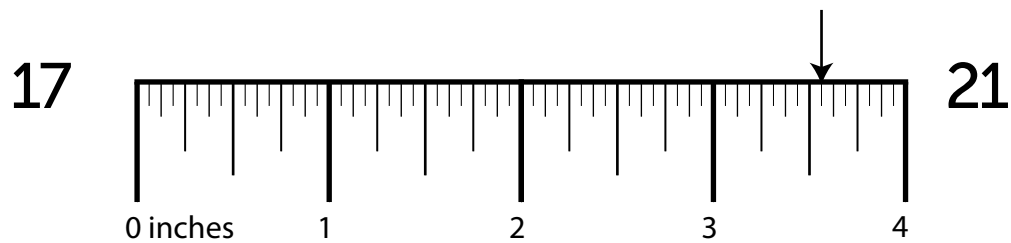
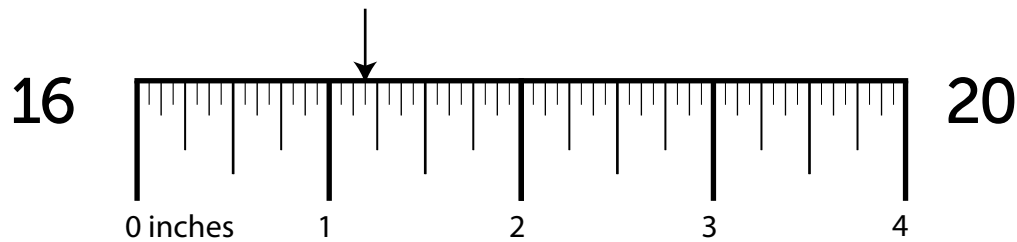
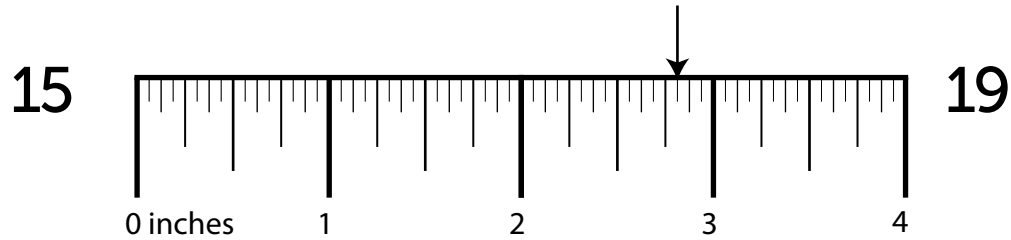

Section IV – More/Less Than

215

23. What is $\frac{1}{4}$ more than $5\frac{1}{2}$? 27. What is $\frac{3}{8}$ less than $1\frac{3}{8}$?
24. What is $\frac{1}{2}$ less than $2\frac{3}{16}$? 28. What is $\frac{1}{4}$ more than $1\frac{1}{16}$?
25. What is $\frac{1}{8}$ less than $3\frac{3}{8}$? 29. What is $\frac{3}{8}$ more than $4\frac{1}{16}$?
26. What is $\frac{1}{16}$ more than $5\frac{5}{16}$? 30. What is $\frac{1}{4}$ more than $4\frac{3}{8}$?

Section V – Nail Penetration & Screw Hole Bits

How far will a ...

What size drill bit will you need to drill a ...

31. 9 penny nail penetrate a 5/8" dry frame?

35. countersink hole for a 18 gauge screw?

32. 5 penny nail penetrate a 4" dry beam?

36. clearance hole for a 16 gauge screw?

33. 3 penny nail penetrate a 4" green dimension?

37. pilot hole for a 14 gauge screw?

34. 5 common gauge nail penetrate a 2" dry girder?

38. pilot hole for a 9 gauge screw?