

Section I – +/– Feet & Inches

211

1. $12' 3'' - 2' 7'' =$

5. $16' 11'' + 8' 4'' =$

2. $17' 9'' - 4' 8'' =$

6. $9' 2'' + 9' 8'' =$

3. $16' 7'' + 15' 2'' =$

7. $14' 8'' + 8' 4'' =$

4. $10' 9'' + 16' 10'' =$

8. $13' 9'' - 9' 5'' =$

DRAWING IS NOT TO SCALE

212

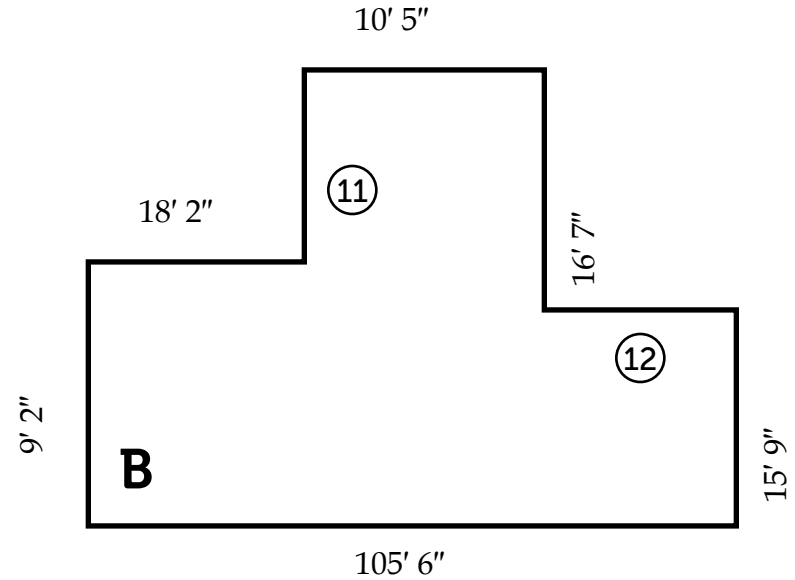
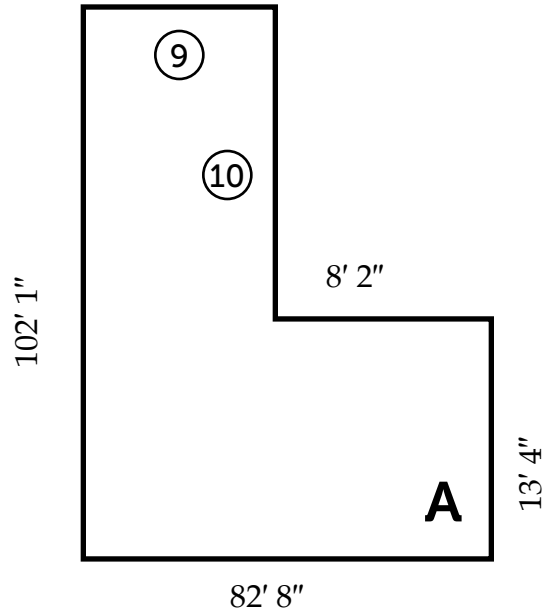

Side	Length	Side	Length	Shape	Perimeter
⑨	_____	⑪	_____	A	⑬ _____
⑩	_____	⑫	_____	B	⑭ _____

DRAWING IS NOT TO SCALE

Section III – Ruler Measurements

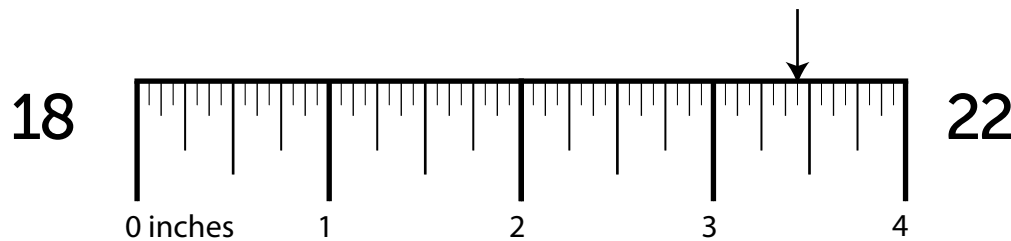
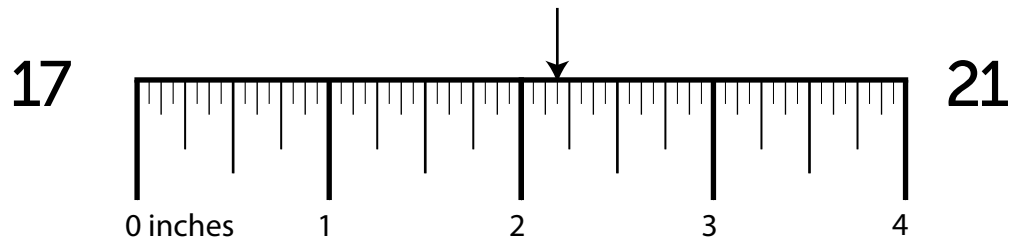
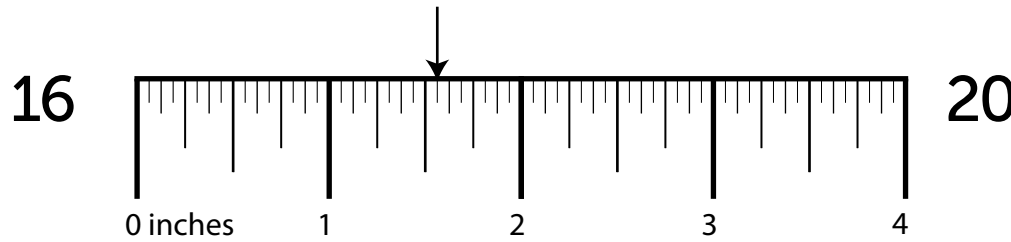
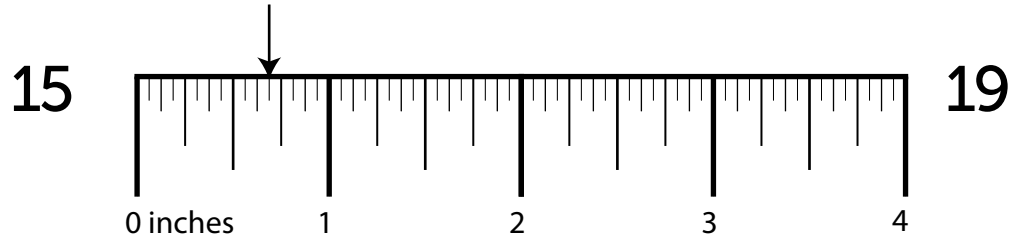

Section IV – More/Less Than

212

23. What is $\frac{1}{2}$ more than $2\frac{1}{4}$? 27. What is $\frac{1}{2}$ less than $1\frac{3}{8}$?
24. What is $\frac{5}{16}$ less than $3\frac{3}{8}$? 28. What is $\frac{1}{2}$ more than $4\frac{1}{2}$?
25. What is $\frac{1}{4}$ less than $4\frac{3}{8}$? 29. What is $\frac{1}{4}$ less than $1\frac{1}{4}$?
26. What is $\frac{1}{4}$ more than $4\frac{3}{8}$? 30. What is $\frac{1}{4}$ less than $5\frac{1}{4}$?

Section V – Nail Penetration & Screw Hole Bits

How far will a ...

What size drill bit will you need to drill a ...

31. 16 penny nail penetrate a 3 1/2" dry plank?

35. countersink hole for a 7 gauge screw?

32. 6 penny nail penetrate a 5/8" dry mast?

36. pilot hole for a 6 gauge screw?

33. 10 penny nail penetrate a 3 1/2" dry dimension?

37. pilot hole for a 4 gauge screw?

34. 8 common gauge nail penetrate a 1/2" dry rafter?

38. countersink hole for a 8 gauge screw?