

Section I — +/– Feet & Inches

346

1. $10' 3'' - 4' 5'' =$

5. $16' 3'' - 10' 4'' =$

2. $18' 11'' + 10' 11'' =$

6. $12' 5'' + 15' 7'' =$

3. $15' 9'' + 14' 9'' =$

7. $14' 3'' + 13' 1'' =$

4. $12' 10'' + 8' 9'' =$

8. $8' 1'' - 11' 9'' =$

Section II — Find the Missing Side & Perimeter

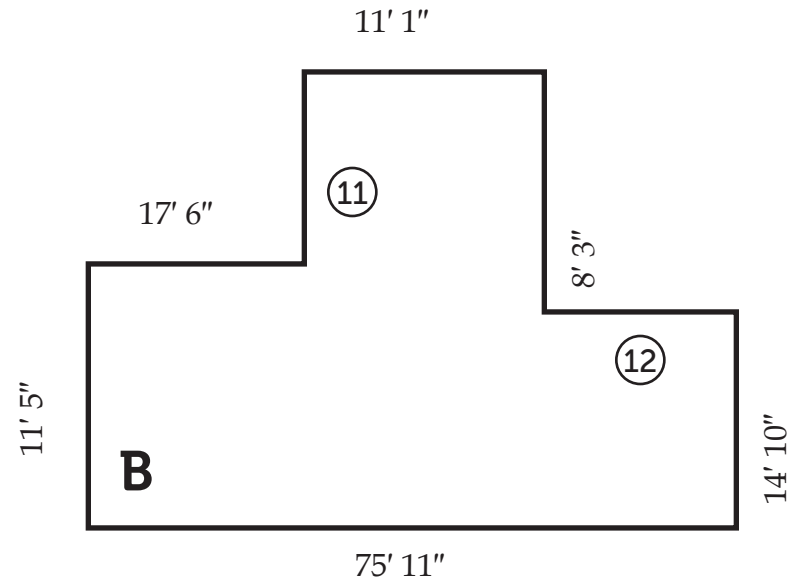
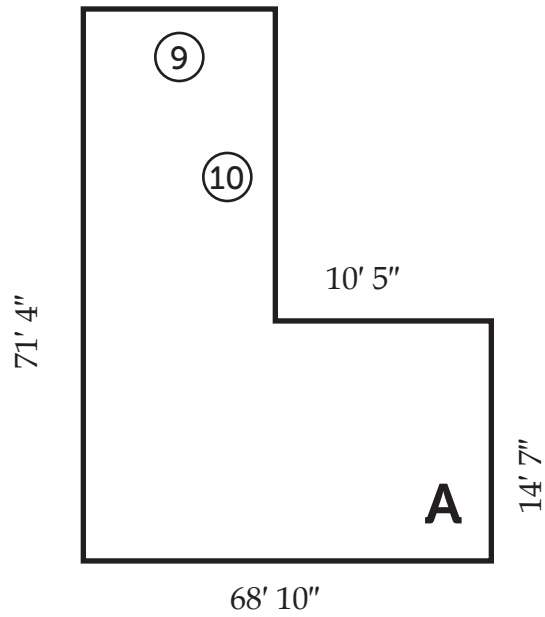

Side	Length	Side	Length	Shape	Perimeter
⑨	_____	⑪	_____	A	⑬ _____
⑩	_____	⑫	_____	B	⑭ _____

Section III – Ruler Measurements

346

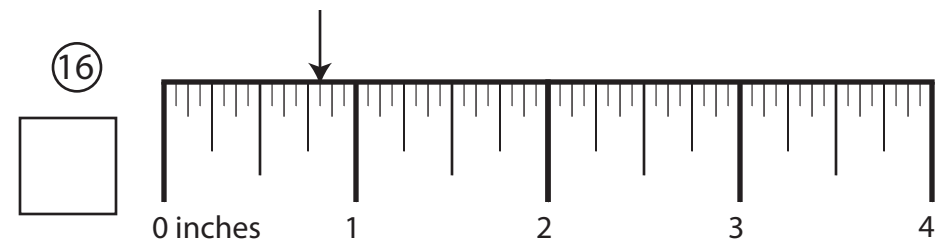
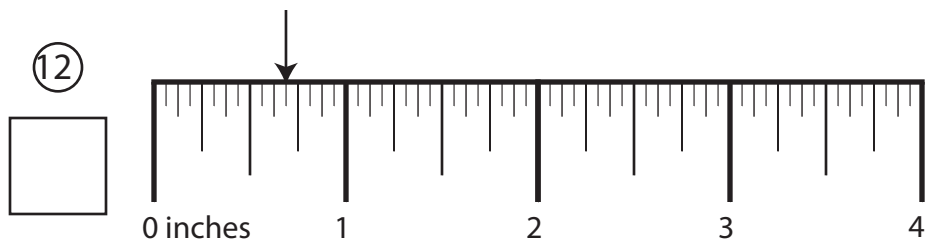
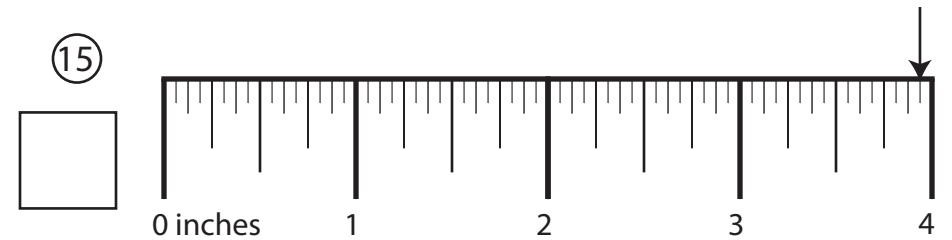
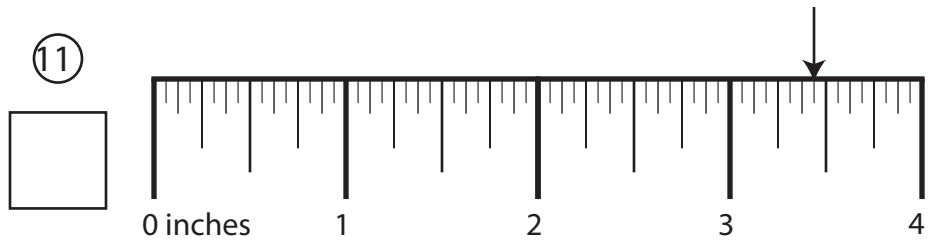
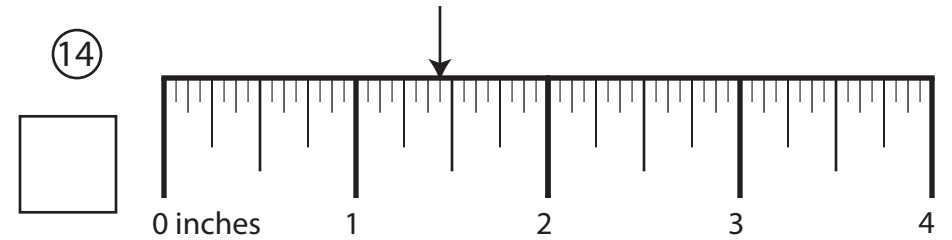
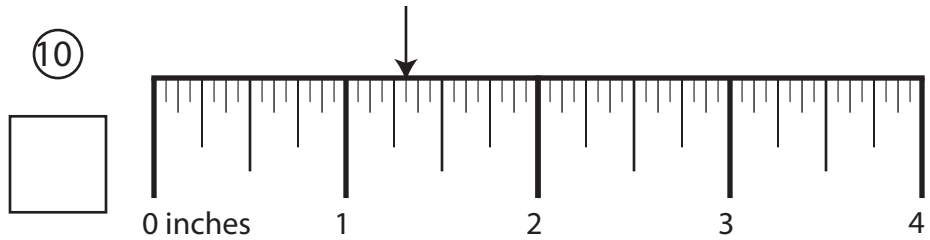
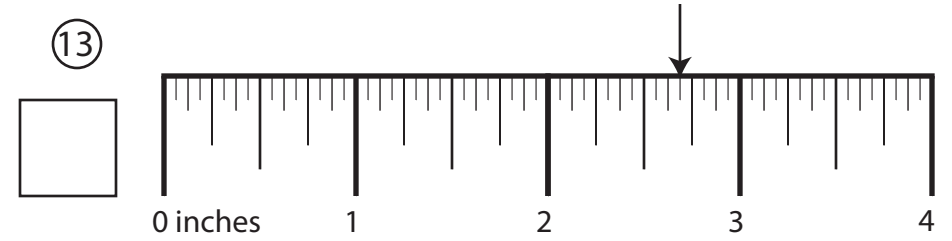
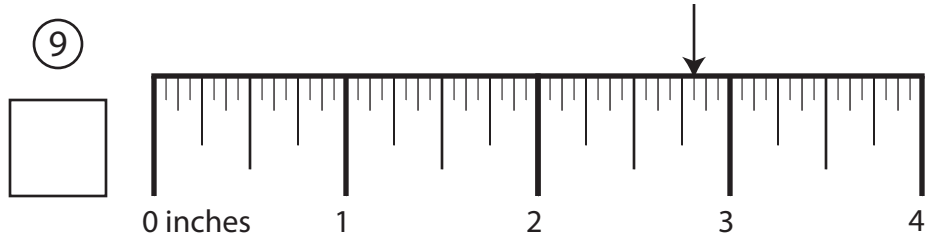

Section IV – More/Less Than

346

23. What is $\frac{1}{16}$ less than $2\frac{1}{2}$? 27. What is $\frac{1}{2}$ less than $5\frac{1}{2}$?
24. What is $\frac{1}{4}$ more than $2\frac{1}{8}$? 28. What is $\frac{3}{8}$ less than $3\frac{1}{2}$?
25. What is $\frac{1}{2}$ less than $3\frac{3}{8}$? 29. What is $\frac{1}{8}$ less than $5\frac{1}{2}$?
26. What is $\frac{1}{2}$ more than $3\frac{1}{8}$? 30. What is $\frac{3}{8}$ more than $3\frac{1}{4}$?

Section V — Nail Penetration & Screw Hole Bits

346*How far will a ...**What drill bit do you need to drill a ...*

[Remember, # or letter only, except 27/64, 14/32, 29/64]

31. 12 ½ common gauge nail penetrate a 4" green beam?
32. 5 common gauge nail penetrate a 3/4" green girder?
33. 8 box gauge nail penetrate a 1 ½" dry beam?
34. 20 penny nail penetrate a 1 ¼" dry plank?
35. pilot hole for a 18 gauge screw?
36. clearance hole for a 8 gauge screw?
37. countersink hole for a 14 gauge screw?
38. countersink hole for a 20 gauge screw?

Section VI – **Math** Calculations**3 4 6**

39. How many pounds of CO₂ are released by burning motor gasoline for 7 weeks in a ET 110-H?
40. How many pounds of CO₂ are released by burning 271 pounds of East.Hophornbeam?
41. How many pounds of CO₂ are released by burning Anthracite coal for 9 hours in a EG-35?
42. Ammonia, 212oF cycle, 1299 (lb/hr) flowrate, outside is 81°F, inside 51°F?
43. How many mmBTUs are generated by running a ULT 399 for 2 weeks?
44. How many pounds of CO₂ are released by burning diesel fuel for 7 months in a GV90+4?
45. Alcohol, ethyl 32oF (ethanol) cycle, 1440 (lb/hr) flowrate, outside is 67°F, inside 56°F?
46. Ammonia, 212oF cycle, 1055 (lb/hr) flowrate, outside is 43°F, inside 44°F?

Section VI – **Math** Calculations**346**

47. Calcium Chloride cycle, 776 (lb/hr) flowrate, outside is 89°F, inside 66°F?
51. Dodecane cycle, 828 (lb/hr) flowrate, outside is 77°F, inside 60°F?
48. How many mmBTUs are generated by running a ET 110-C for 1 weeks?
52. n-Butane, 320°F cycle, 856 (lb/hr) flowrate, outside is 58°F, inside 90°F?
49. Alcohol, methyl. 60 - 70°F cycle, 562 (lb/hr) flowrate, outside is 53°F, inside 88°F?
53. How many mmBTUs are generated by running a EG-35 for 8 weeks?
50. Alcohol, ethyl 104°F (ethanol) cycle, 748 (lb/hr) flowrate, outside is 87°F, inside 63°F?
54. How many pounds of CO₂ are released by burning kerosene for 8 weeks in a CGI-8?

Section VII – Blueprint Calculations

346

55. Shape C, Scale = 24, molding job. 59. Shape I, Scale = 32, paint job.

56. Shape E, Scale = 8, paint job.

60. Shape M, Scale = 48, panel job.

57. Shape D, Scale = 50, wire job.

61. Shape R, Scale = 30, baseboard job.

58. Shape J, Scale = 50, baseboard job

62. Shape Q, Scale = 48, molding job.